

APPLICATIONS

REQUEST

MAP #

Parkway

08/PW-01 Contee Crossing II

5 to 3

1

08/PW-02 Humphreys, LLC

S5 to S3

2

Western Branch

08/W-07 Foreign Car Parts

S5 to S3

3

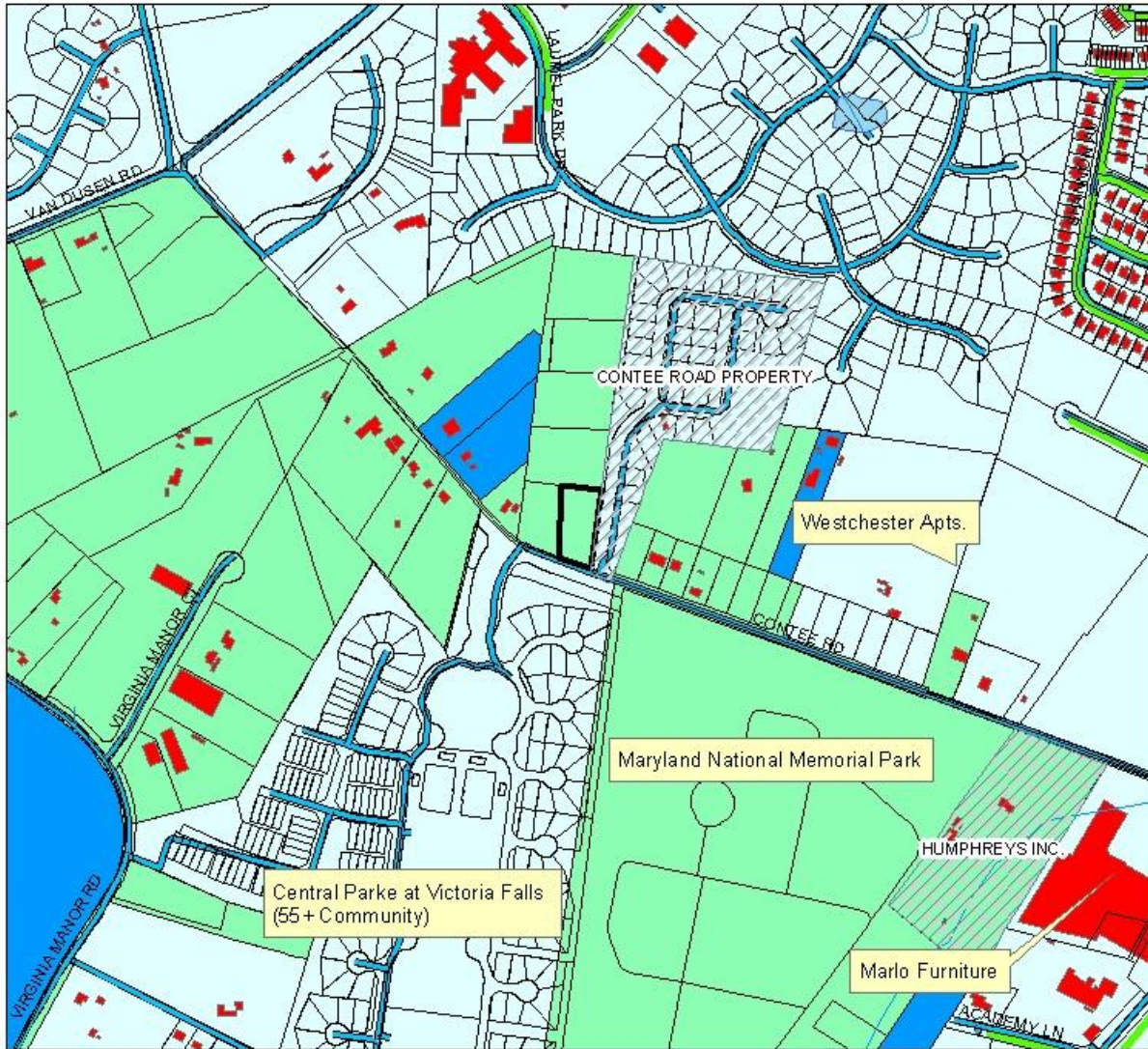

Envelope Boundary	Streams	Ponds	Buildings	Streets	Railroad	Bridges	Water lines	Sewer lines	Property	Council District 1	Bridges	Schools	Firestations	Historic sites
Sewer Categories														
	S-3	Community System												
	S-4c	Conditional Approval for Category 3												
	S-4	Community System Adequate for Development Planning												
	S-5	Future Community system												
	S-6	Individual System												

0 250 500 1,000 feet



084120810001.ppr20081105

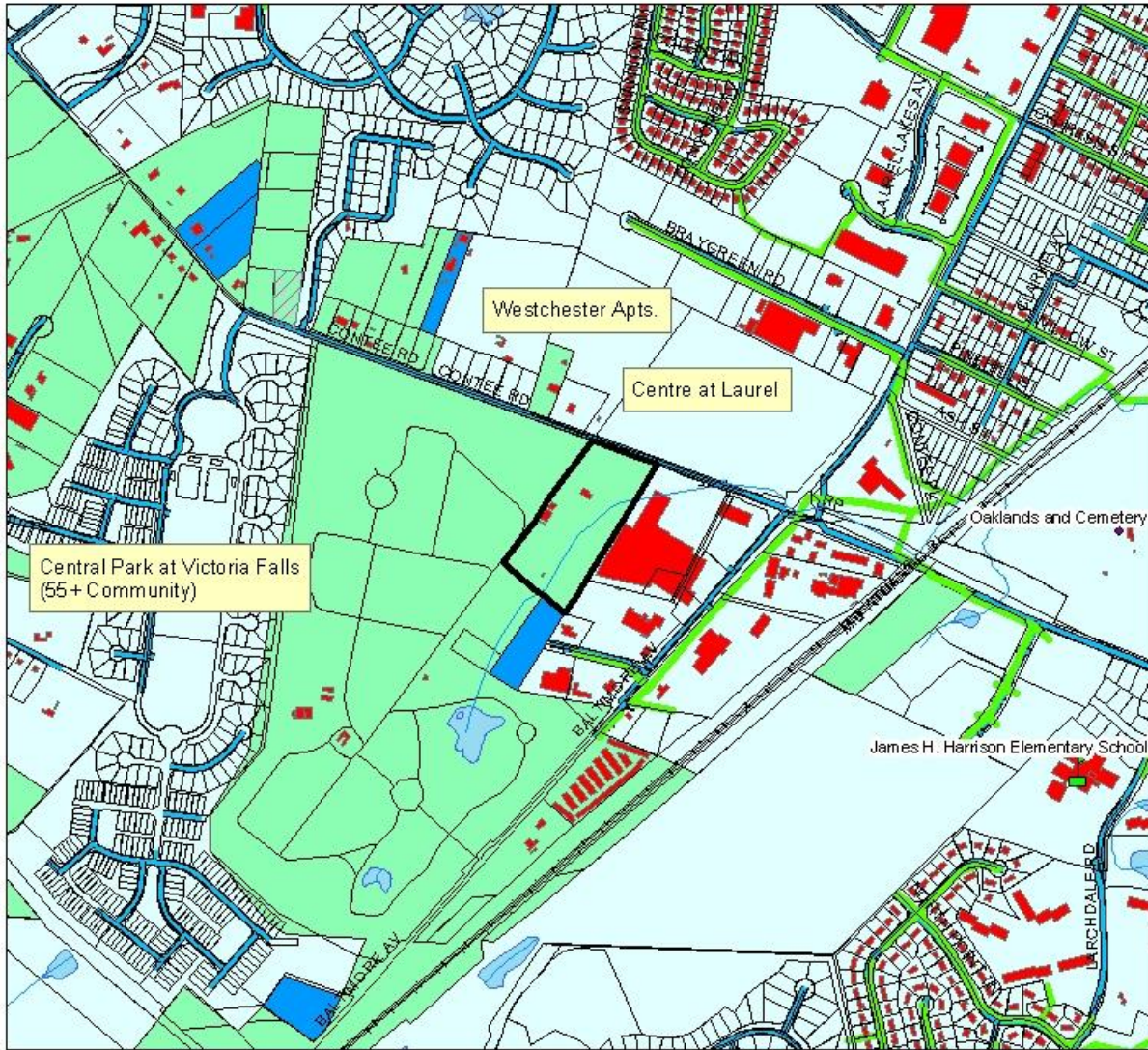

	Envelope Boundary		
	Streams		
	Ponds		
	Buildings		
	Streets		
	Railroad		
	Bridges		
	Water lines		
	Sewer lines		
	Property		
			Schools
			Firestations
			Historic sites

Council District 1

Sewer Categories

	S-3 Community System
	S-4c Conditional Approval for Category 3
	S-4 Community System Adequate for Development Planning
	S-5 Future Community system
	S-6 Individual System



084120100001pr2008100

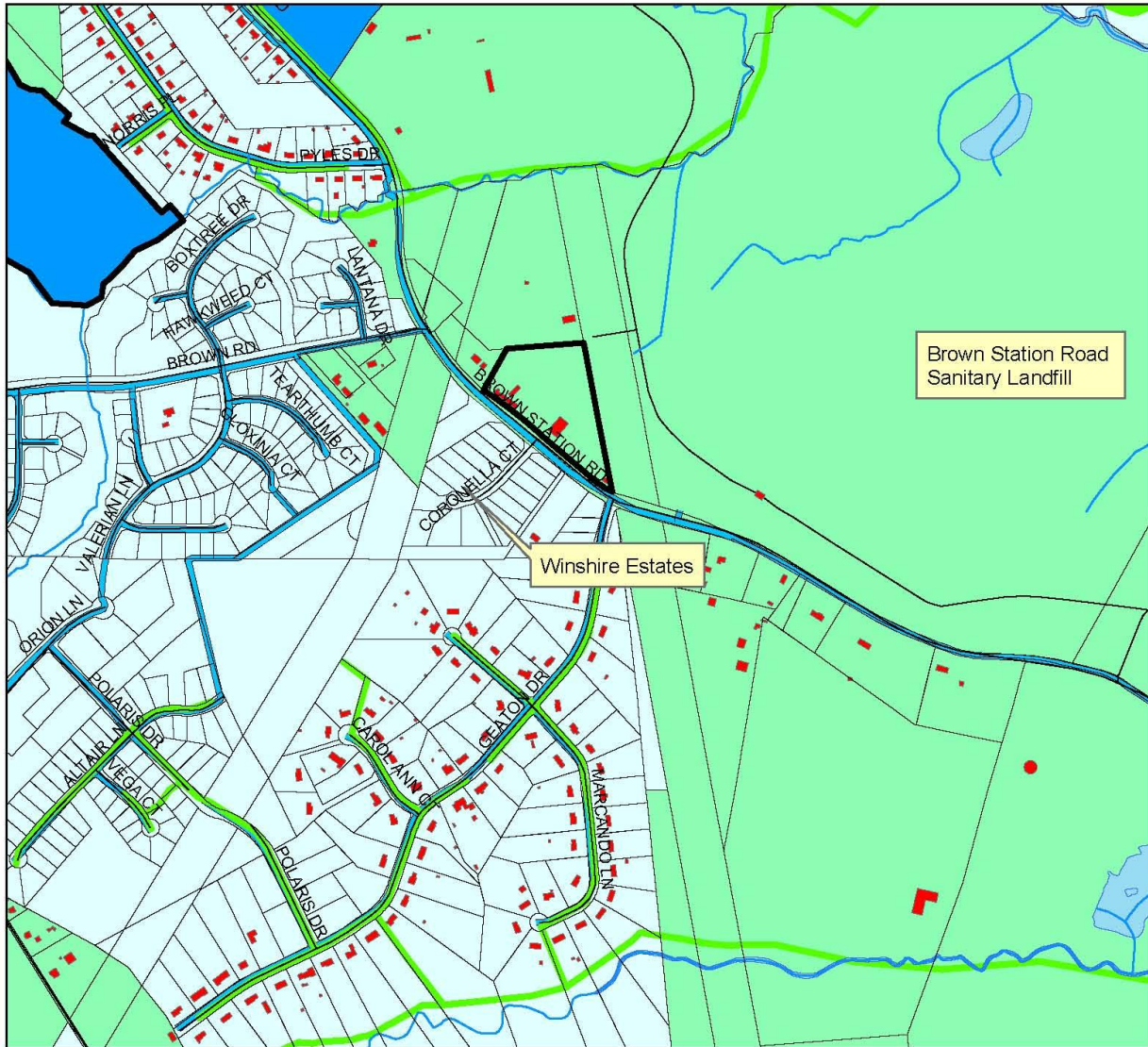

- Envelope Boundary
 - Streams
 - Ponds
 - Buildings
 - Streets
 - Railroad
 - Bridges
 - Water lines
 - Sewer lines
 - Property
 - Schools
 - Firestations
 - Historic sites
- Council District 6
- Sewer Categories**
- S-3 Community System
 - S-4c Conditional Approval for Category 3
 - S-4 Community System Adequate for Development Planning
 - S-5 Future Community system
 - S-6 Individual System

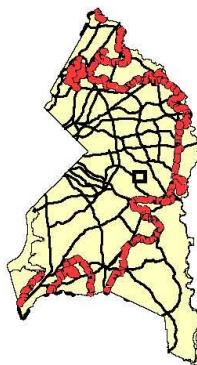

G:\MSB\shore\apr\2008\MXD