

WATER AND SEWER CATEGORY AMENDMENT

Sewershed Application Council District	Development Proposal/ Tax Map Location	Acreage/ Zoning	Current Category	Requested Category	Executive's Recommendation	Council Approval
<u>Parkway</u>						
19/PW-01 Patuxent Greens Golf Course District 1	167 SFD and 222 TH residential dwelling units 6, F-4, Parcel A and Unknown Parcel	191.75 PUD-E Laurel	4	3	3	3
<u>Western Branch</u>						
19/W-01 Hawkins Property District 6	100 – 150 TH residential dwelling units with a minimum 2,000 SF of livable space; minimum sale price \$325K; retail and office space with a minimum rent of \$30/per sq. ft. 45, F-3, Parcels 5, 118 & 123	22.29 R-E	5	4	5	*
19/W-02 Freeway Airport District 6	44 SFD residential dwelling units with a minimum 3,500 SF of livable space; minimum sale price \$600K. 54, B/C-2/3/4; Parcels 7, 49, 50, 51, 57, 58, 59 & 60	128.94 R-A	5	4	4	4
<u>Mattawoman</u>						
19/M-01 Signature Club Outparcel B District 9	Redesignation of Outparcel B as a buildable parcel to be developed as a unified development with Lot 12 for residential uses and commercial retail uses. 161, E-2, Parcel B	3.62 M-X-T	5	4	4	4

*- Application Deferred to the August 2019 Cycle (at applicant's request)

- Category 3 – Community System
- Category 4 – Community System Adequate for Development Planning
- Category 5 – Future Community System
- Category 6 – Individual System

APPLICATIONS

REQUEST

MAP #

Parkway

19/PW-01

Patuxent Greens Golf Course

4 to 3

1

Western Branch

19/W-01

Hawkins Property

5 to 4

2

19/W-02

Freeway Airport

5 to 4

3

Mattawoman

19/M-01

Signature Club Outparcel B

5 to 4

4



Angela D. Alsobrooks
County Executive

Patuxent Greens Golf Course

Amendment Request 4 to 3

April 2019 LA Cycle
Application: 19/PW-01

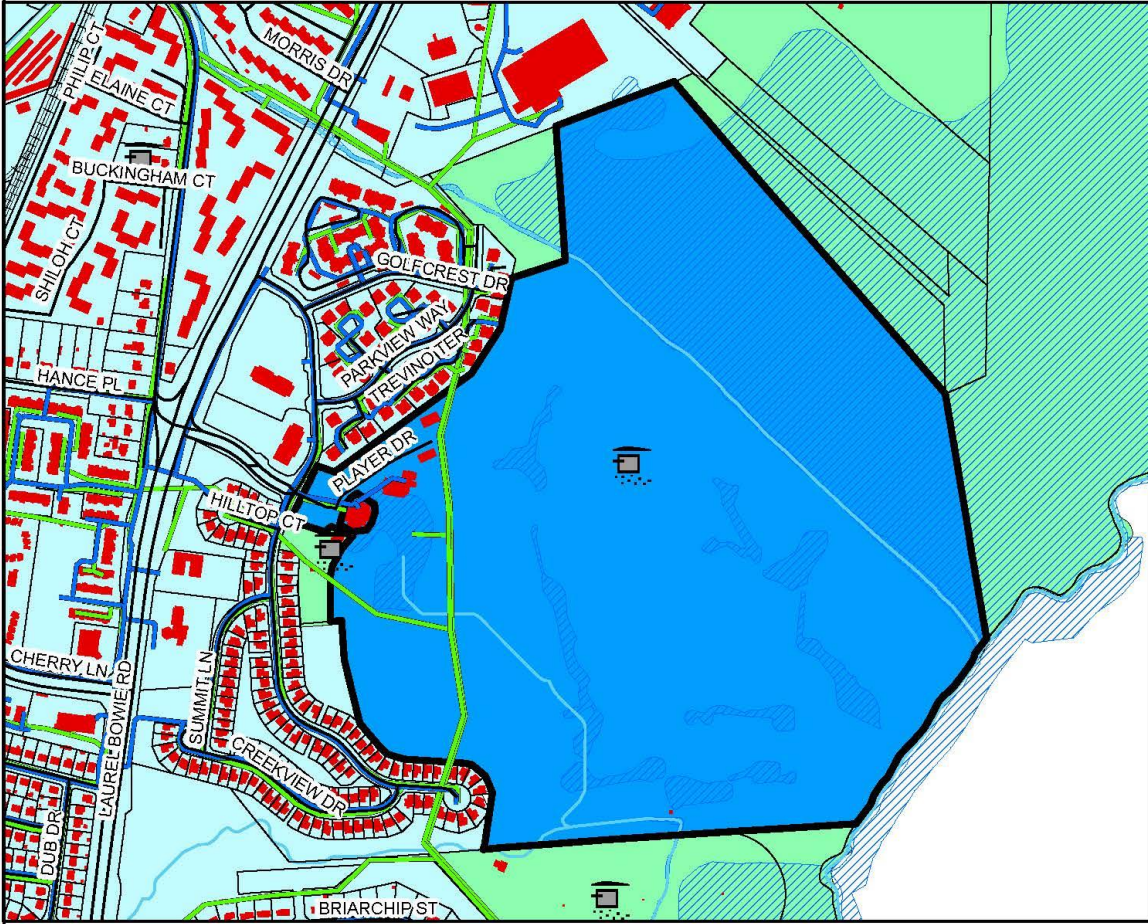

	RAILROADS
	Streets
	Septic1
	Envelope
	a2008
	BUILDINGS
	Property
	streams
	PONDS
	MARLBOROCLAY
Sewer	
	S-3 Community System
	S-4 Community System Adequate for Development Planning
	S-5 Future Community System
	S-6 Individual System
	S-6P Private, Shared or Community System

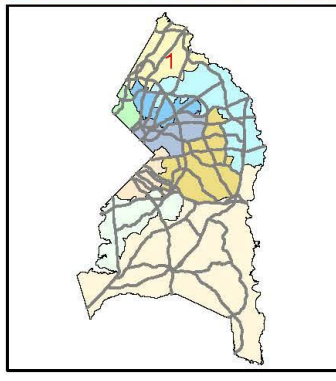

Prince George's County Government, Maryland
Department Of Permitting, Inspections And Enforcement
Site/Road Plan Review Division



J:\Water_Sewer\MKD\Tony's MKD's Maps



Angela D. Alsobrooks
County Executive

Hawkins Property

Amendment Request 5 to 4



April 2019 LA Cycle
Application: 19/W-01

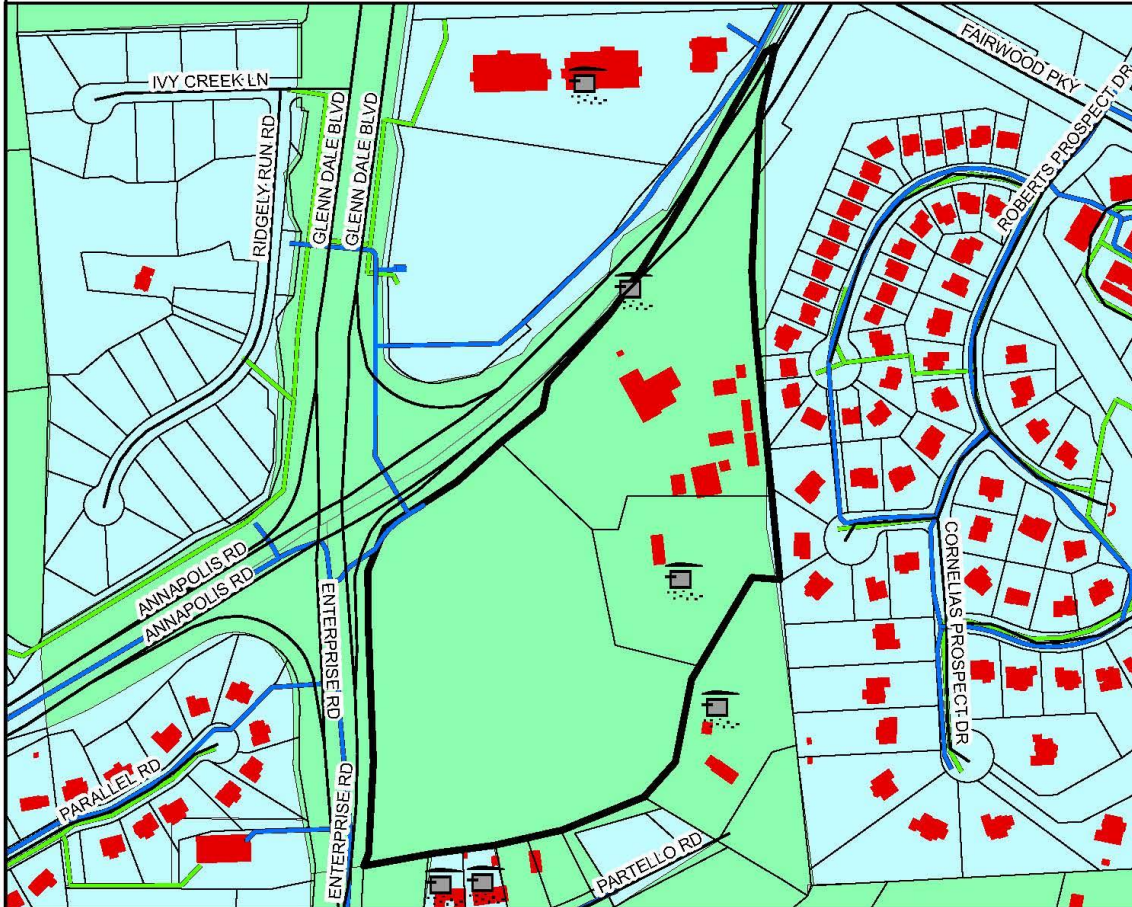

RAILROADS	
—	Streets
*	Septic
—	Envelope
■	a2008
BUILDINGS	
■	Property
—	streams
▨	PONDS
■	MARLBOROCLAY
Sewer	
■	S-3 Community System
■	S-4 Community System Adequate for Development Planning
■	S-5 Future Community System
■	S-6 Individual System
■	S-6P Private, Shared or Community System

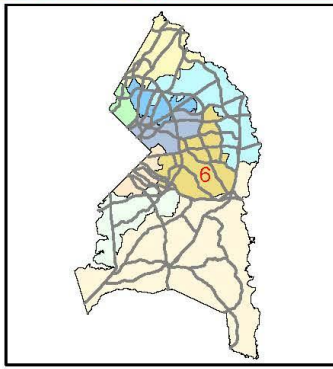

Prince Georges's County Government, Maryland
Department of Permitting, Inspections And Enforcement
Site/Road Plan Review Division



J:\Water_Sewer\MKD\Tony's MKD's Maps



Angela D. Alsobrooks
County Executive

Freeway Airport

Amendment Request 5 to 4



April 2019 LA Cycle
Application: 19/W-02

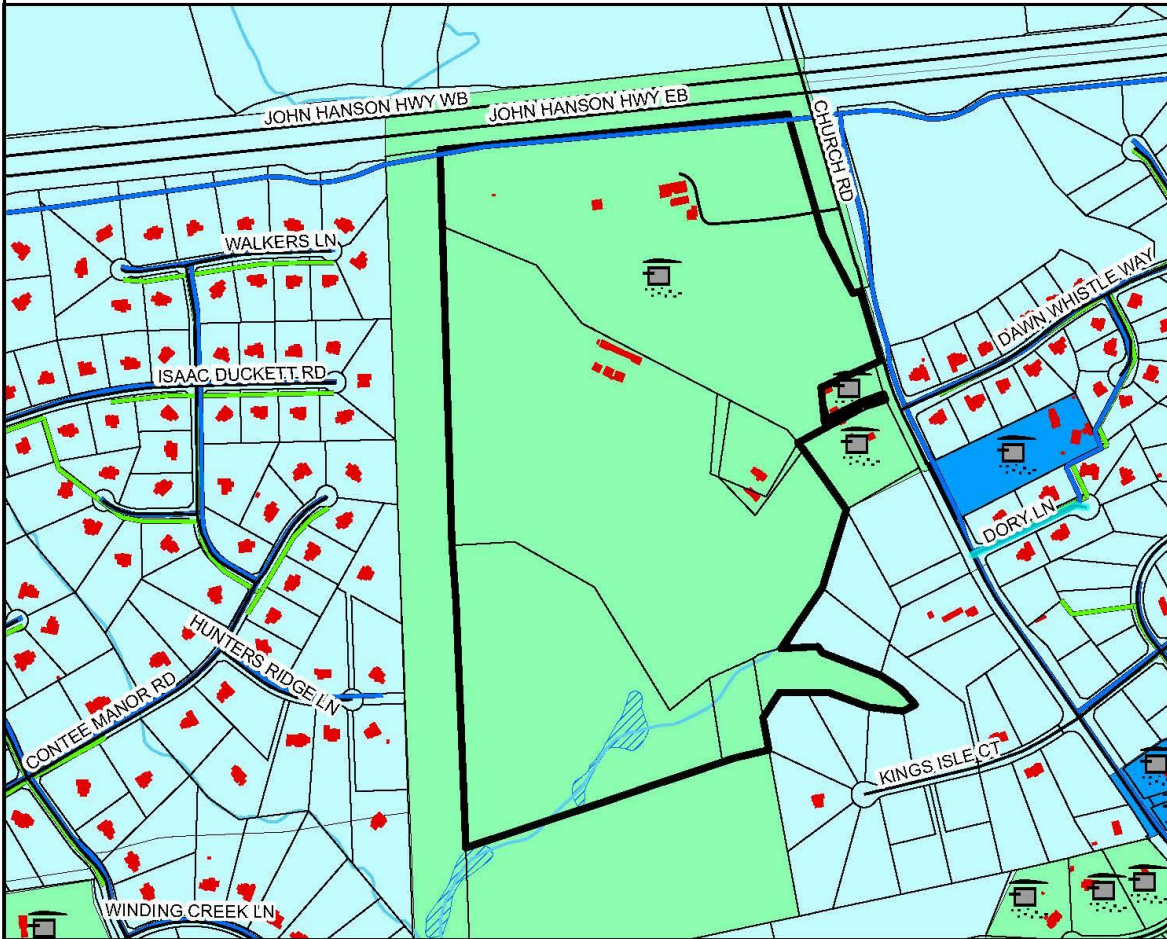

RAILROADS	
	Railroads
Streets	
	Streets
	Septic1
	Envelope
	a2008
BUILDINGS	
	Property
	streams
	PONDS
	MARLBOROCLAY
Sewer	
	S-3 Community System
	S-4 Community System Adequate for Development Planning
	S-5 Future Community System
	S-6 Individual System
	S-6P Private, Shared or Community System

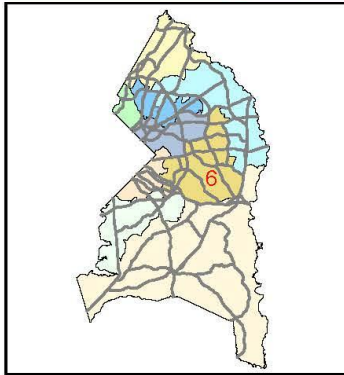

Prince George's County Government, Maryland
Department Of Permitting, Inspections And Enforcement
Site/Road Plan Review Division



J:\Water_Sewer\MKD\Tony's M/D's\Maps



Angela D. Alsobrooks
County Executive

Signature Club Parcel B

Amendment Request 5 to 4



April 2019 LA Cycle
Application: 19/M-01

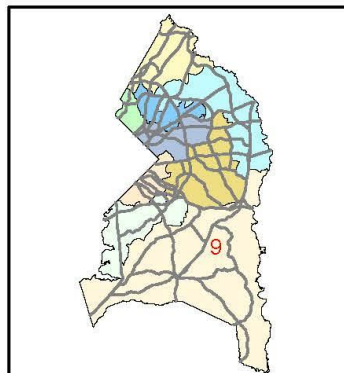
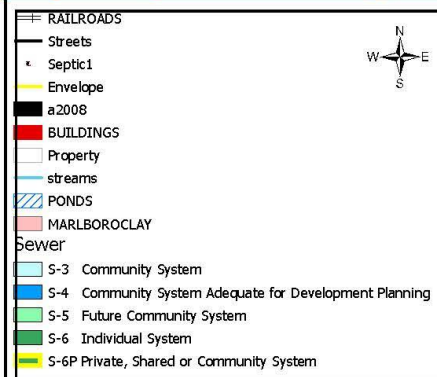

Prince George's County Government, Maryland
Department Of Permitting, Inspections And Enforcement
Site/Road Plan Review Division



J:\Water_Sewer\MXD\Tony's MXD's\Maps