

# LOL CHILDCARE STATION

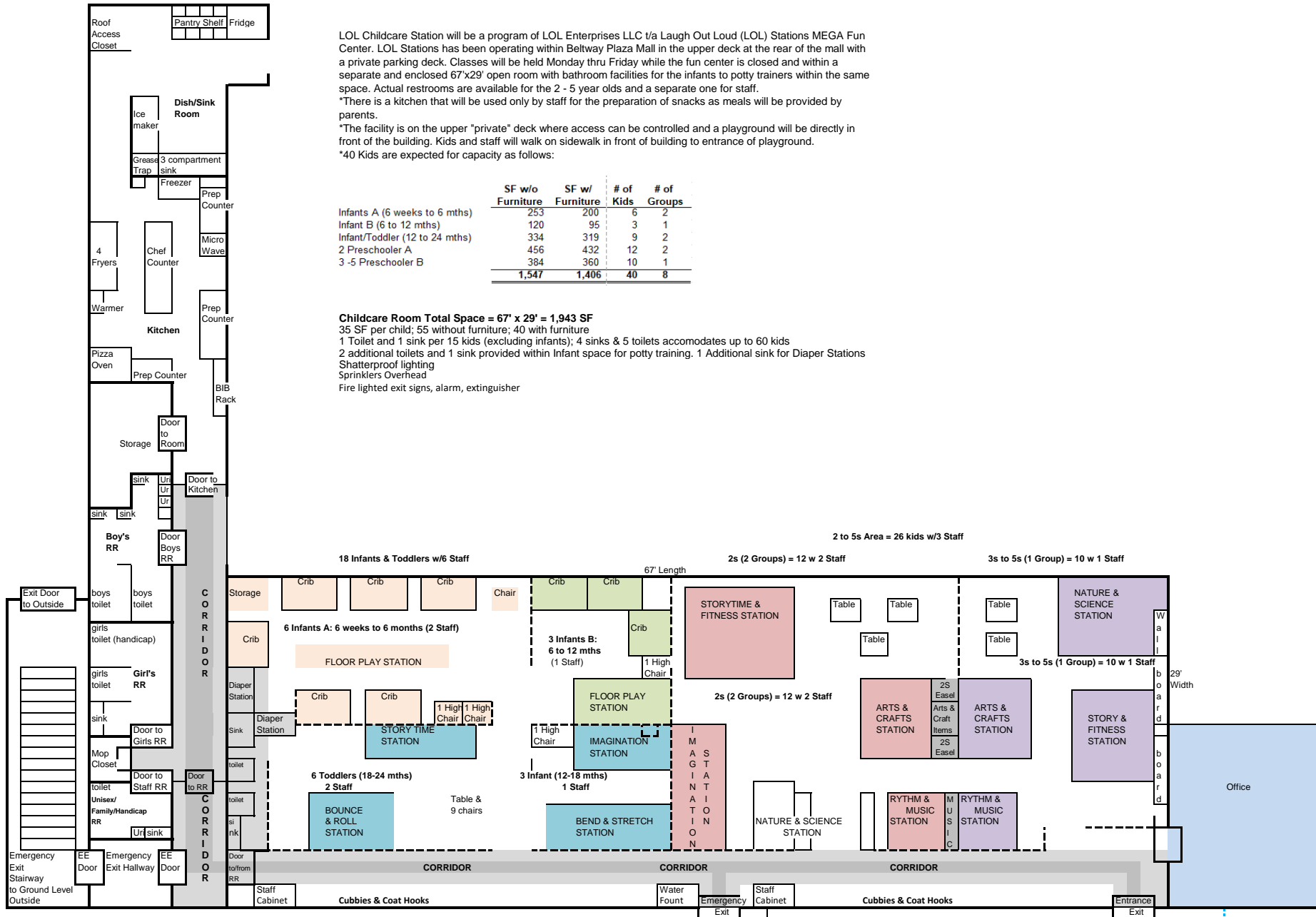

LOL Childcare Station will be a program of LOL Enterprises LLC t/a Laugh Out Loud (LOL) Stations MEGA Fun Center. LOL Stations has been operating within Beltway Plaza Mall in the upper deck at the rear of the mall with a private parking deck. Classes will be held Monday thru Friday while the fun center is closed and within a separate and enclosed 67'x29' open room with bathroom facilities for the infants to potty trainers within the same space. Actual restrooms are available for the 2 - 5 year olds and a separate one for staff.  
 \*There is a kitchen that will be used only by staff for the preparation of snacks as meals will be provided by parents.  
 \*The facility is on the upper "private" deck where access can be controlled and a playground will be directly in front of the building. Kids and staff will walk on sidewalk in front of building to entrance of playground.  
 \*40 Kids are expected for capacity as follows:

|                                | SF w/o Furniture | SF w/ Furniture | # of Kids | # of Groups |
|--------------------------------|------------------|-----------------|-----------|-------------|
| Infants A (6 weeks to 6 mths)  | 253              | 200             | 6         | 2           |
| Infant B (6 to 12 mths)        | 120              | 95              | 3         | 1           |
| Infant/Toddler (12 to 24 mths) | 334              | 319             | 9         | 2           |
| 2 Preschooler A                | 456              | 432             | 12        | 2           |
| 3-5 Preschooler B              | 384              | 360             | 10        | 1           |
| <b>Total</b>                   | <b>1,547</b>     | <b>1,406</b>    | <b>40</b> | <b>8</b>    |

**Childcare Room Total Space = 67' x 29' = 1,943 SF**  
 35 SF per child; 55 without furniture; 40 with furniture  
 1 Toilet and 1 sink per 15 kids (excluding infants); 4 sinks & 5 toilets accomodates up to 60 kids  
 2 additional toilets and 1 sink provided within Infant space for potty training. 1 Additional sink for Diaper Stations  
 Shatterproof lighting  
 Sprinklers Overhead  
 Fire lighted exit signs, alarm, extinguisher

18 Infants & Toddlers w/6 Staff  
 2s (2 Groups) = 12 w 2 Staff  
 3s to 5s (1 Group) = 10 w 1 Staff

6 Infants A: 6 weeks to 6 months (2 Staff)  
 3 Infants B: 6 to 12 mths (1 Staff)  
 2s (2 Groups) = 12 w 2 Staff  
 3s to 5s (1 Group) = 10 w 1 Staff

6 Toddlers (18-24 mths) 2 Staff  
 3 Infant (12-18 mths) 1 Staff

Corridor  
 Staff Cabinet  
 Water Fountain  
 Emergency Exit  
 Staff Cabinet  
 Cubbies & Coat Hooks  
 Entrance Exit