

APPLICATIONS

REQUEST

MAP #

Western Branch

08/W-01	Colt's Neck (Race Track Road/Engleman Property)	1
08/W-02	Calvary Chapel Breath of Life	2
08/W-03	Moore Farm Property	3
08/W-04	Westphalia Center	4
08/W-05	Westphalia Center Extended	5
08/W-06	Walker Pontiac	6

Water and Sewer Plan Amendments

April 2008 Application

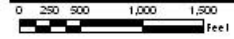
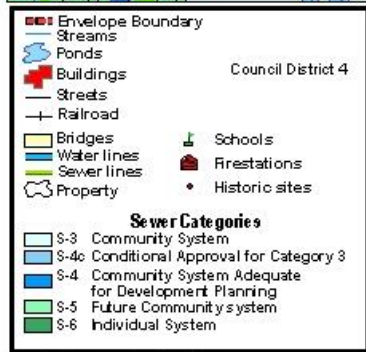
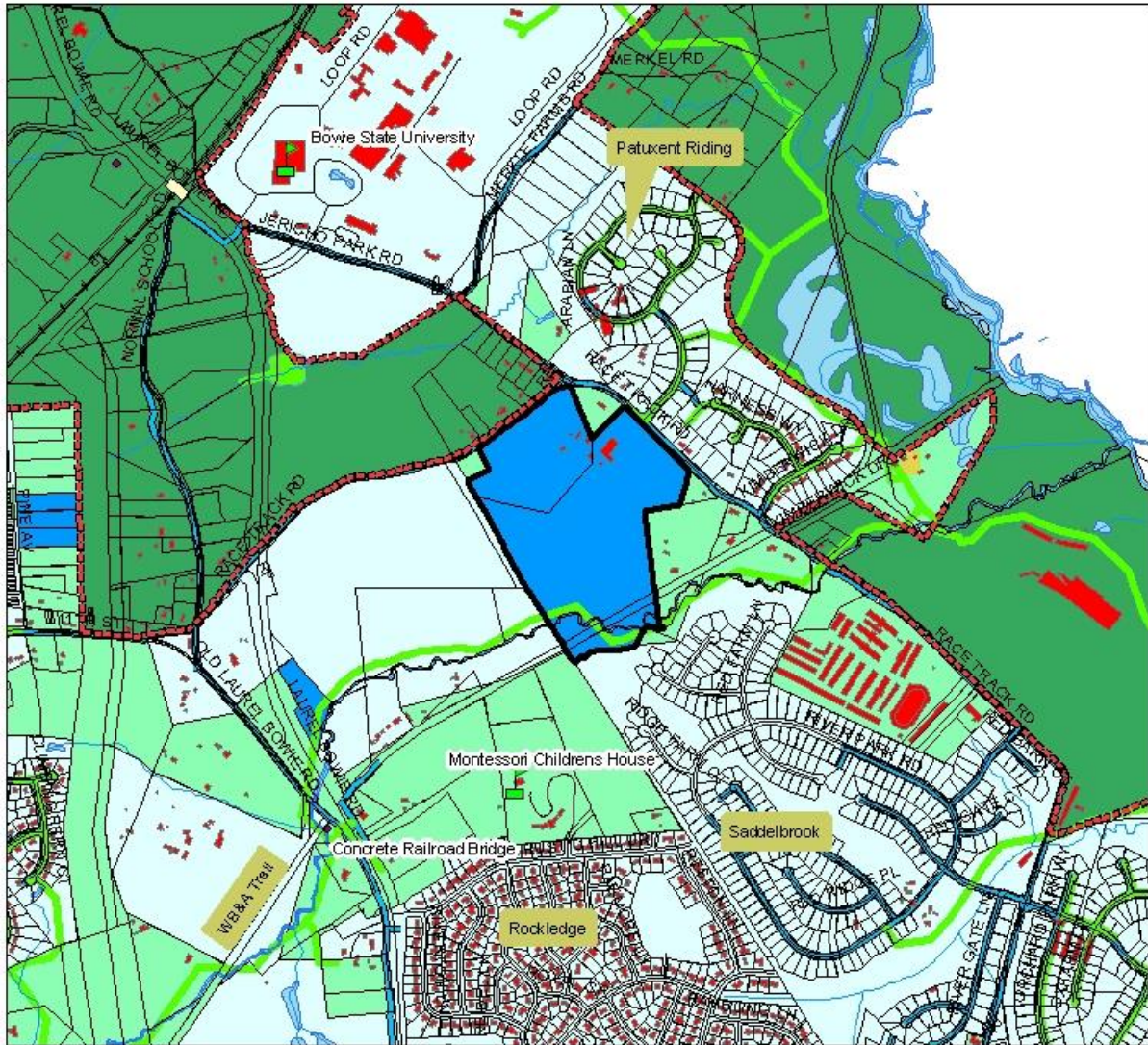

Colt's Neck April 2008

Water and Sewer Plan Amendments

April 2008 Application

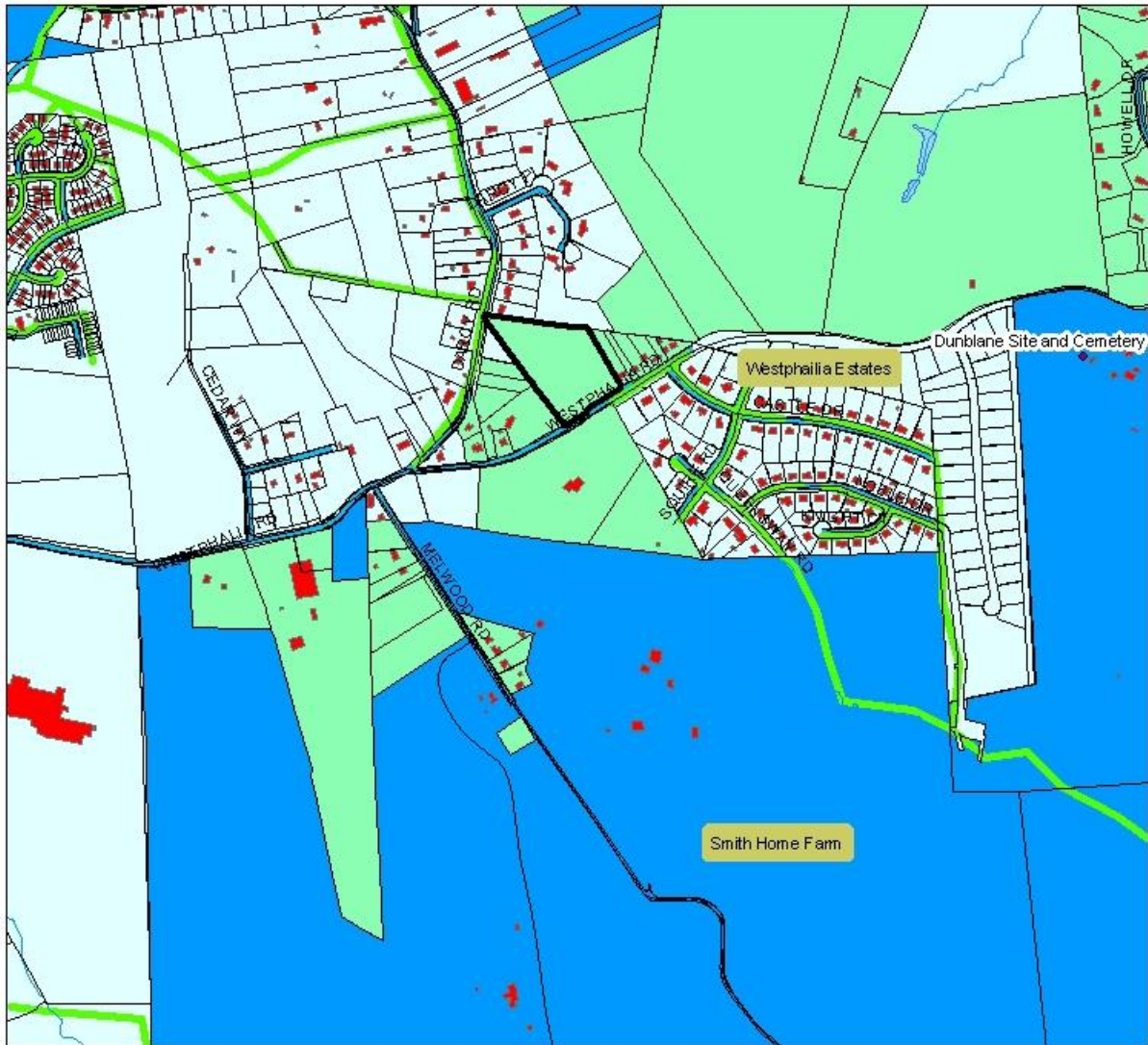

	Envelope Boundary		Ponds
	Streams		Buildings
	Streets		Railroad
	Bridges		Schools
	Water lines		Firestations
	Sewer lines		Historic sites
	Property		

Council District 6

Sewer Categories

- S-3 Community System
- S-4c Conditional Approval for Category 3
- S-4 Community System Adequate for Development Planning
- S-5 Future Community system
- S-6 Individual System

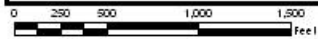

GMI 4/16/08 from app2/03084.XD

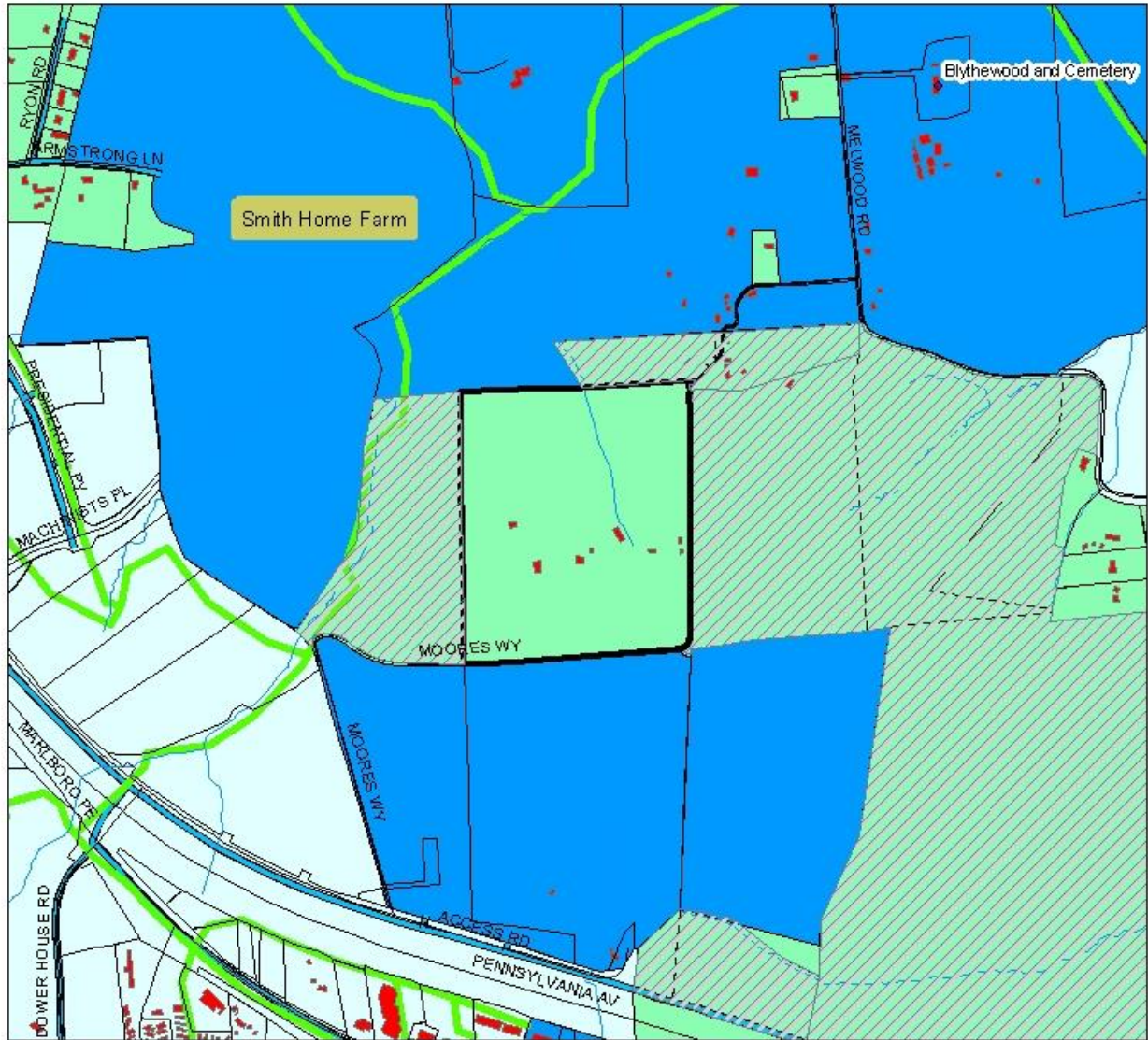

	Envelope Boundary		Streams
	Ponds		Buildings
	Streets		Railroad
	Bridges		Water lines
	Sewer lines		Property
	Property		Envelope Boundary

	Property in Current Legislative Review
	Schools
	Firestations
	Historic sites

Sewer Categories

	S-3 Community System
	S-4c Conditional Approval for Category 3
	S-4 Community System Adequate for Development Planning
	S-5 Future Community system
	S-6 Individual System



Call 484.661.4400 for more information

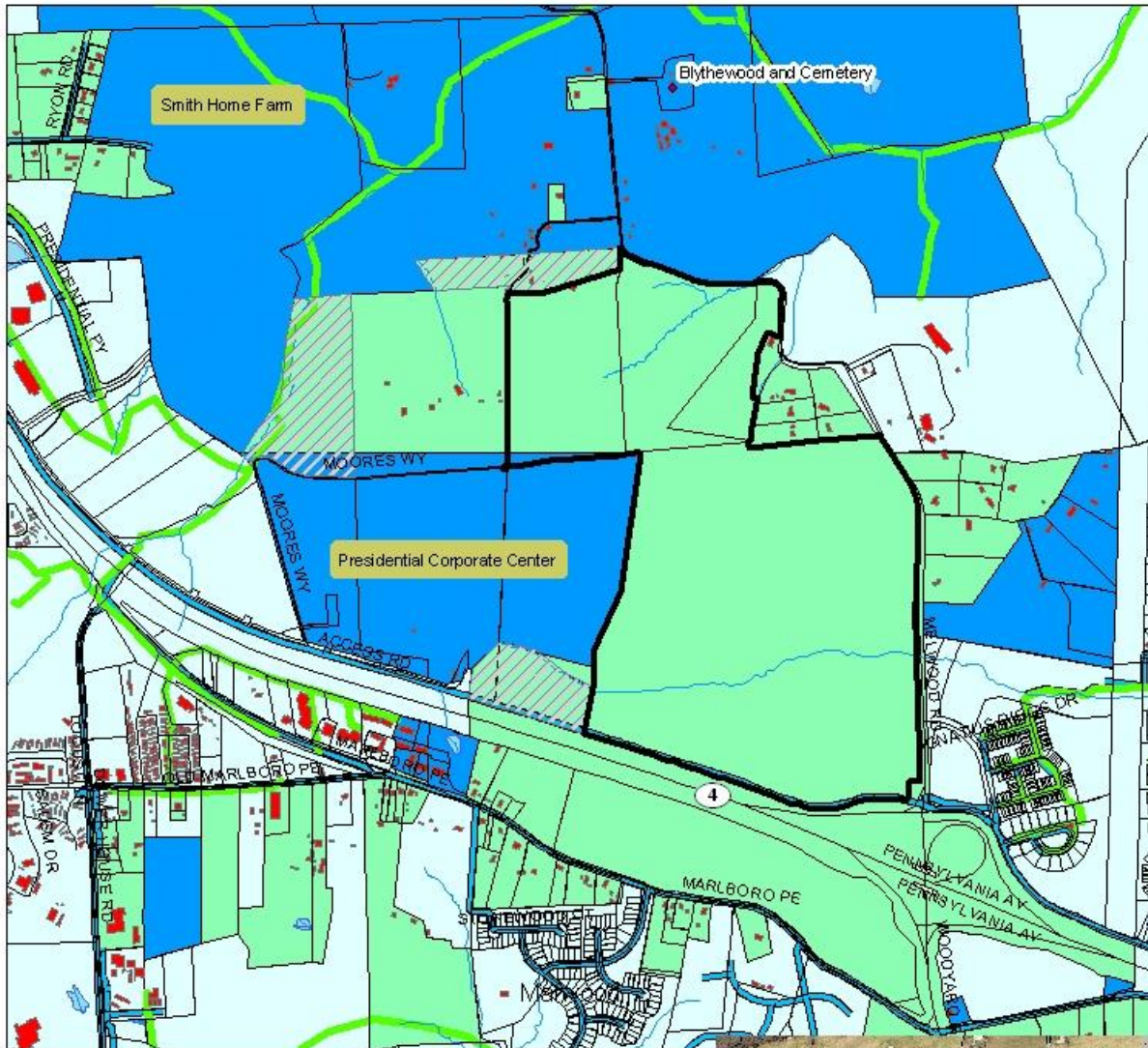

	Envelope Boundary		Streams
	Ponds		Buildings
	Streets		Railroad
	Bridges		Schools
	Water lines		Firestations
	Sewer lines		Historic sites
	Property		

Council District 6

Sewer Categories

- S-3 Community System
- S-4c Conditional Approval for Category 3
- S-4 Community System Adequate for Development Planning
- S-5 Future Community system
- S-6 Individual System

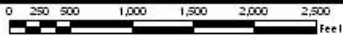

G:\08\08w-04\app\0308130

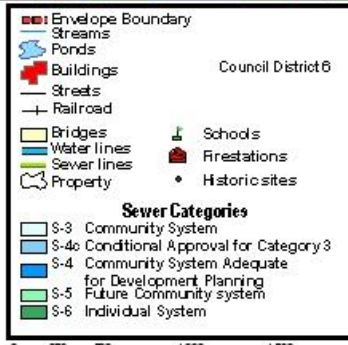
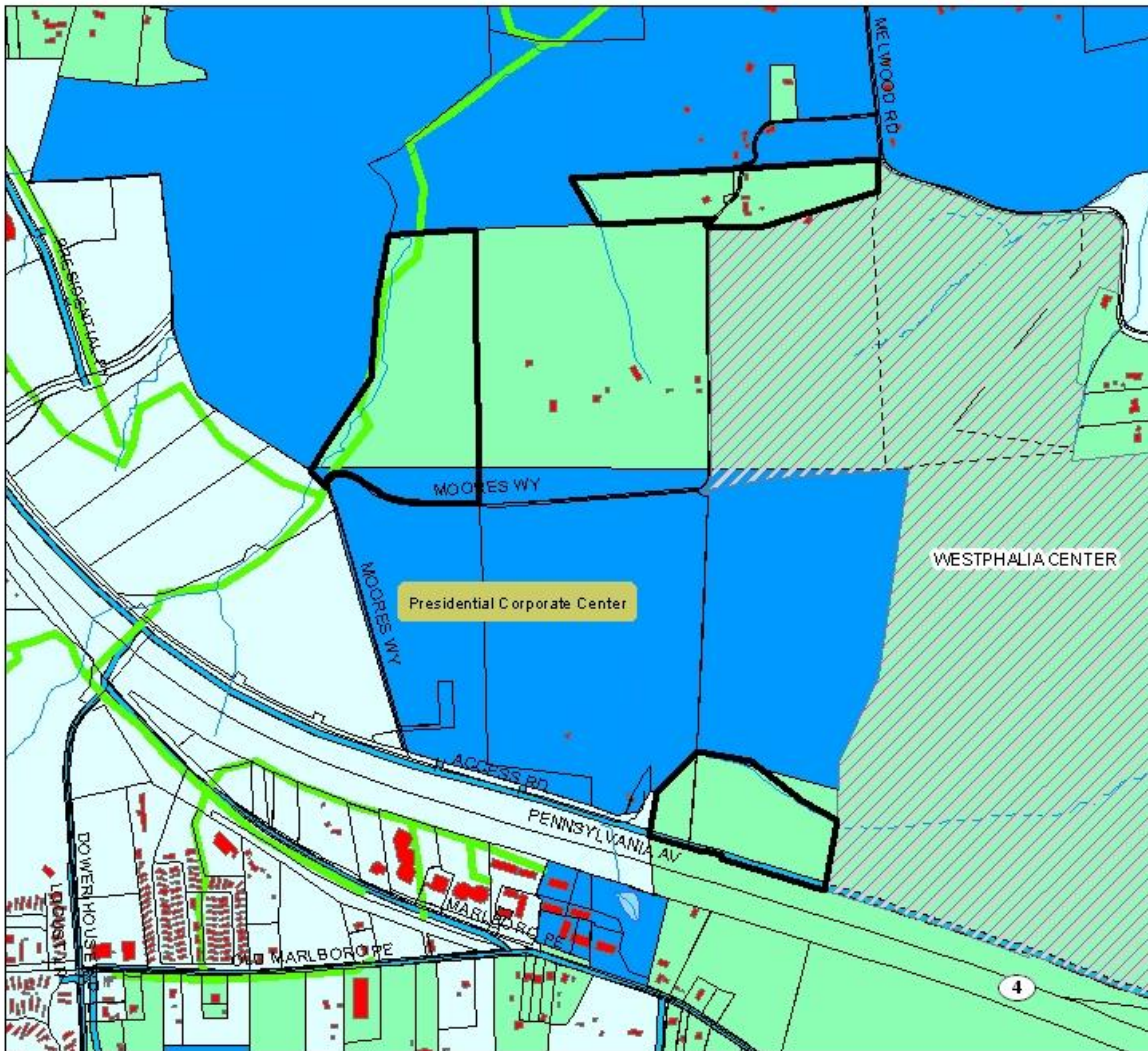

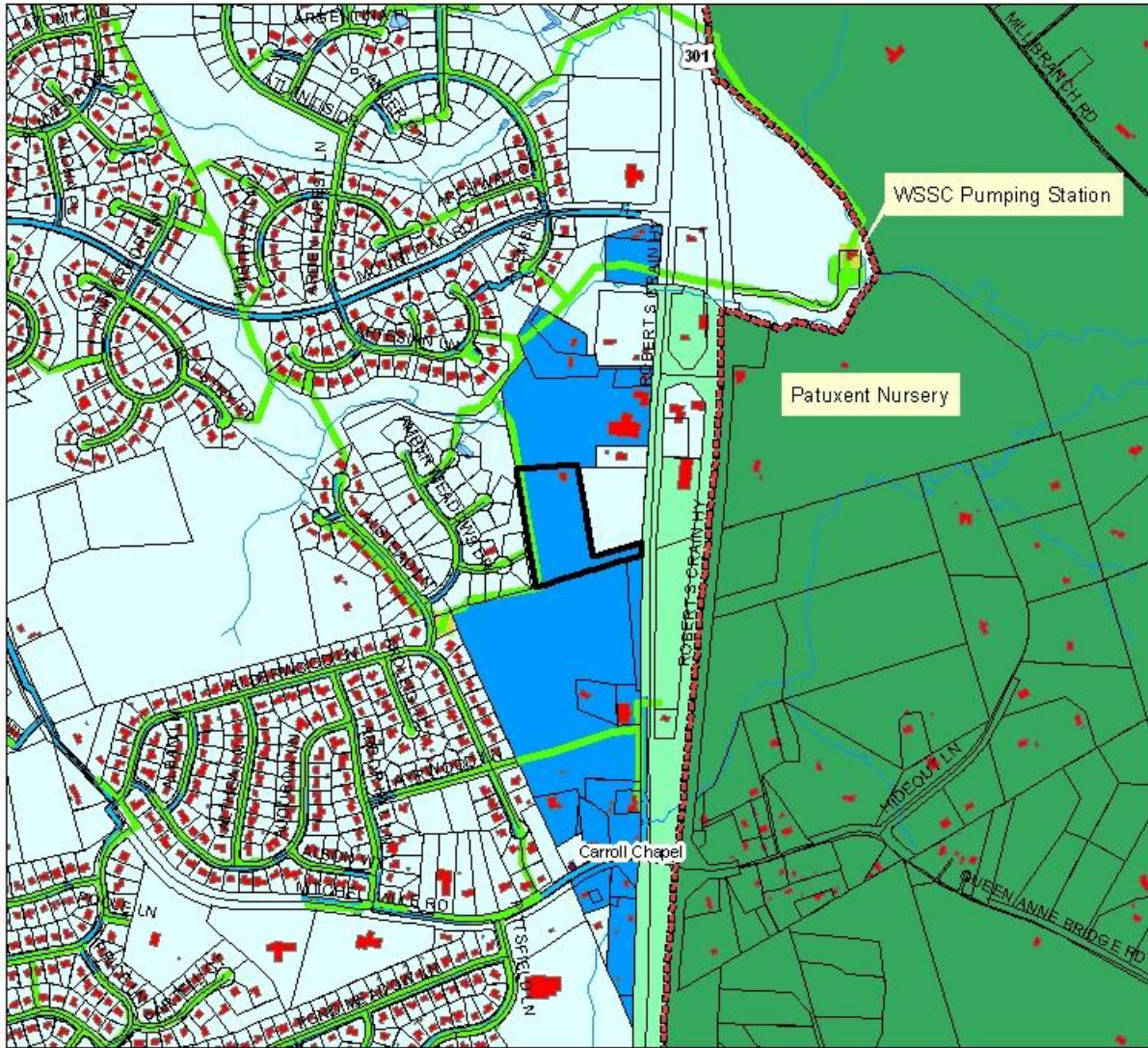

- Envelope Boundary
 - Streams
 - Ponds
 - Buildings
 - Streets
 - Railroad
 - Bridges
 - Water lines
 - Sewer lines
 - Property
 - Schools
 - Firestations
 - Historic sites
- Sewer Categories**
- S-3 Community System
 - S-4c Conditional Approval for Category 3
 - S-4 Community System Adequate for Development Planning
 - S-5 Future Community system
 - S-6 Individual System

