

**Split-Zoned R-18 & C-S-C**  
**Properties, minimum 5 Acres**

**Prince George's County**

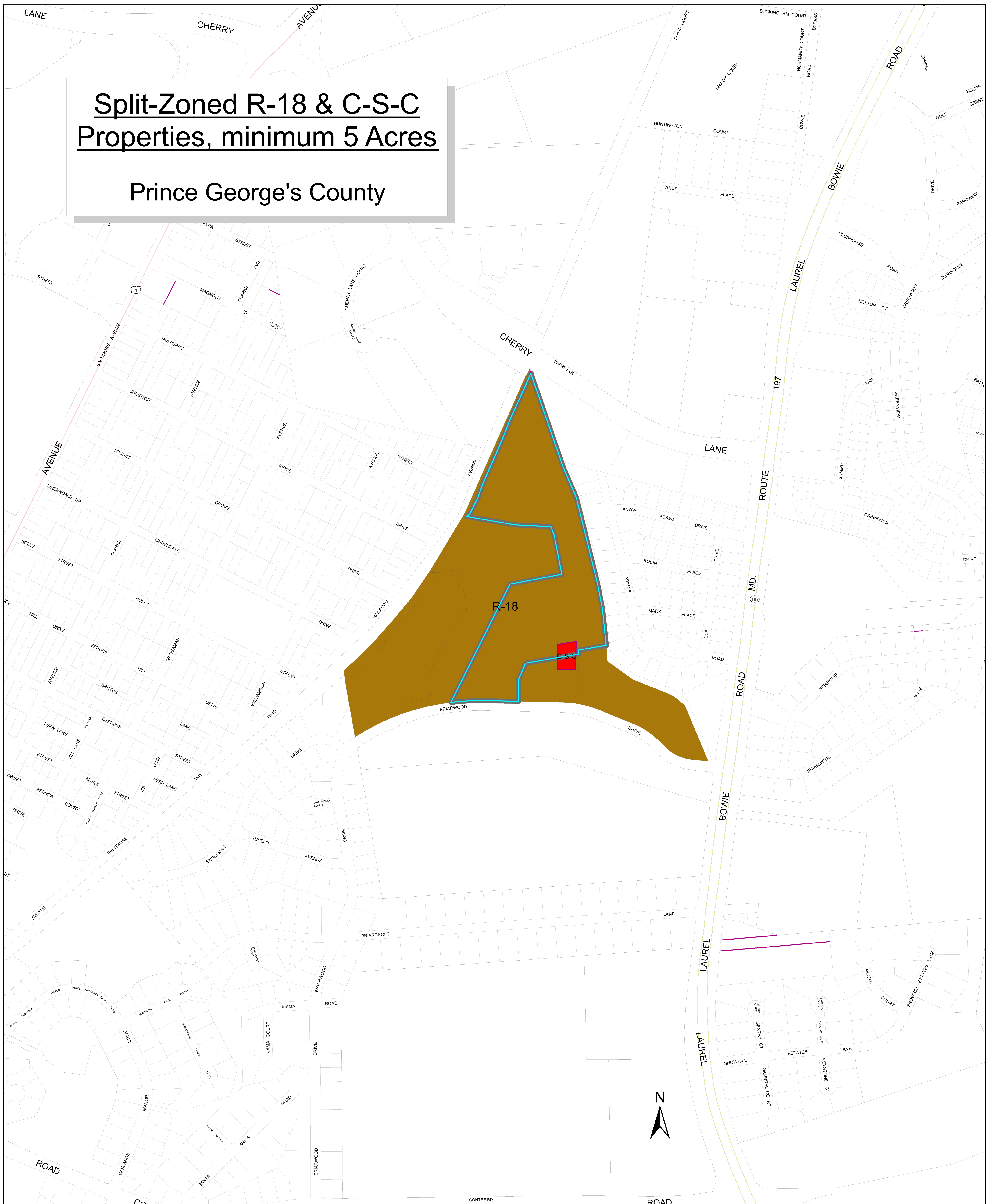

The Maryland - National Capital  
Park and Planning Commission  
Prince George's County Planning Department  
Geographic Information System

0 0.05 0.1  
Miles  
1:2,500

Date Created/Delivered: 9/15/21  
Author: Keith Wright  
GIS Map & Data Request #: 11334  
Archive: J:\GIS\_Projects\Keith.Wright\Requests\...\_11334.zip

This map may not be reproduced, stored in a retrieval system, or transmitted by any form, including electronic or by photo reproduction, without the express written permission of The Maryland-National Capital Park and Planning Commission. For more information, contact the Prince George's County Planning Department in Upper Marlboro, Maryland.