

COUNTY COUNCIL OF PRINCE GEORGE'S COUNTY, MARYLAND
2006 Legislative Session

Resolution No. CR-74-2006
Proposed by Council Member Peters
Introduced by Council Member Peters
Co-Sponsors _____
Date of Introduction September 26, 2006

RESOLUTION

1 A RESOLUTION concerning

2 The Washington Suburban Sanitary Commission Fiscal Years

3 2007-2012 Capital Improvements Program

4 for Prince George's County for Water and Sewerage

5 For the purpose of amending the WSSC Fiscal Years 2007 –2012 Capital Improvement Program
6 for Water and Sewerage.

7 WHEREAS, Article 29, Section 7-106 of the Annotated Code of Maryland requires the
8 Washington Suburban Sanitary Commission (hereinafter "WSSC") to submit a Capital
9 Improvements Program and any amendments thereto to the County Executive and County
10 Council of Prince George's County; and

11 WHEREAS, this WSSC Capital Improvement Program is part of the Adopted County
12 Comprehensive Ten Year Water and Sewerage Plan and contains projects to support water
13 supply and sewerage system development as proposed in the plan; and

14 WHEREAS, the County Council did not adopt the "WSSC Capital Improvements Program
15 for Fiscal Years 2007-2012 and Operating Budget for Fiscal Year 2007 which resulted in a
16 default budget. (A default budget is the original WSSC Capital Improvements Program for
17 Fiscal Years 2007-2012 and an Operating Budget for FY 2007 that was submitted by WSSC);
18 and

19 WHEREAS, Article 29, Section 7-106 of the Annotated Code of Maryland further provides
20 that after notice to the public and a public hearing, the County Council shall approve, disapprove
21 or modify the WSSC Capital Improvement Program; and

22 WHEREAS, all other requirements of Article 29, Title 7 of the Annotated Code of

1 Maryland that concern final action by the Council on the WSSC Capital Improvement Program
2 for Water Sewerage and for Stormwater management have been met;

3 NOW, THEREFORE, BE IT RESOLVED by the County Council of Prince George's
4 County, Maryland, that the "Capital Improvements Program Fiscal Years 2007-2012 and the
5 Capital and Operating Budget Fiscal Year 2007 for Water and Sewerage." is hereby amended by
6 the attached Appendix 1.

Adopted this 24th day of October, 2006.

COUNTY COUNCIL OF PRINCE
GEORGE'S COUNTY, MARYLAND

BY: _____
Thomas E. Dernoga
Chairman

ATTEST:

Redis C. Floyd
Clerk of the Council

| | | | | | |
|---|------------|-------------|-----------------------------|--------------------|-------------------------|
| A. Identification and Coding Information | | | 2. Date: September 26, 2006 | 7. Pre PDF Pg.No.: | 8. Req. Adeq. Pub. Fac. |
| 1. Agency Number | DSP Number | New Project | Revised: | | |
| S-187.00 | S-86.18 | No | | | |
| 3. Project Name: DSP & Conceptual Design Sewer Projects | | | 5. Agency: WSSC | | |
| 4. DSP Name: Oak Creek Club Sewer (DA3113A01, DA3113B01, DA3113G01) | | | | | |

| B. Expenditure Schedule (000's) | | | | | | | | | | | |
|---------------------------------|-------|----------------|--------------------|------------------|------------------|------------------|------------------|------------------|------------------|------------------|-------------------|
| | (8) | (9) | (10) | (11) | (12) | (13) | (14) | (15) | (16) | (17) | (18) |
| Cost Elements | Total | Thru FY '05 | Estimate FY '06 | Total 6 Years | Year 1 FY '07 | Year 2 FY '08 | Year 3 FY '09 | Year 4 FY '10 | Year 5 FY '11 | Year 6 FY '12 | Beyond 6 Years |
| Planning, Design & Supervision | 109 | 78 | 26 | 5 | 5 | | | | | | |
| Land | | | | | | | | | | | |
| Site Improvements & Utilities | | | | | | | | | | | |
| Construction | 1,528 | 460 | 600 | 468 | 368 | 100 | | | | | |
| Other | 165 | | 94 | 71 | 56 | 15 | | | | | |
| Total | 1,802 | 538 | 720 | 544 | 429 | 115 | | | | | |

| C. Funding Schedule (000's) | | | | | | | | | | |
|-----------------------------|-------|-----|-----|-----|-----|-----|--|--|--|--|
| Contribution/Other | 1,802 | 538 | 720 | 544 | 429 | 115 | | | | |

D. Description & Justification**DESCRIPTION**

3,497 feet of 18-inch diameter sewer main, 1,409 feet of 20-inch diameter sewer main and 583 feet of 21-inch diameter sewer main to provide service to the Oak Creek Club Subdivision. Capacity: 3.05 MGD; Service Area: Mitchellville and Vicinity of Western Branch; Population: 4,000; Status: C-100%; Total Project Cost: \$1,802,000. Released for service 4/21/06. Design and construction were performed by the developer under a System Extension Permit. No WSSC rate-supported debt will be used for this project.

| |
|--|
| E. Annual Operating Budget Impact (000's) |
| |

| |
|---|
| F. Approval and Expenditure Data (000's) |
| |

| |
|------------------------------|
| G. Status Information |
| |



| | | | | |
|---|------------|-------------|-----------------------------|--|
| A. Identification and Coding Information | | | 2. Date: September 26, 2006 | 7. Pre PDF Pg.No.: 8. Req. Adeq. Pub. Fac. |
| 1. Agency Number | DSP Number | New Project | Revised: | |
| S-187.00 | S-86.19 | Yes | | |
| 3. Project Name: DSP & Conceptual Design Sewer Projects | | | 5. Agency: WSSC | |
| 4. DSP Name: Karington Subdivision Sewer | | | | |

| B. Expenditure Schedule (000's) | | | | | | | | | | | |
|---------------------------------|-------|----------------|--------------------|------------------|------------------|------------------|------------------|------------------|------------------|------------------|-------------------|
| | (8) | (9) | (10) | (11) | (12) | (13) | (14) | (15) | (16) | (17) | (18) |
| Cost Elements | Total | Thru FY '05 | Estimate FY '06 | Total 6 Years | Year 1 FY '07 | Year 2 FY '08 | Year 3 FY '09 | Year 4 FY '10 | Year 5 FY '11 | Year 6 FY '12 | Beyond 6 Years |
| Planning, Design & Supervision | 116 | | | 116 | 14 | 39 | 63 | | | | |
| Land | | | | | | | | | | | |
| Site Improvements & Utilities | | | | | | | | | | | |
| Construction | 580 | | | 580 | 80 | 193 | 307 | | | | |
| Other | 105 | | | 105 | 14 | 35 | 56 | | | | |
| Total | 801 | | | 801 | 108 | 267 | 426 | | | | |

| C. Funding Schedule (000's) | | | | | | | | | | |
|-----------------------------|-----|--|--|-----|-----|-----|-----|--|--|--|
| Contribution/Other | 801 | | | 801 | 108 | 267 | 426 | | | |

D. Description & Justification**DESCRIPTION**

5,400 feet of 15 and 18-inch sewer main to serve the Karington subdivision. Capacity: 1.7 to 2.87 MGD; Service Area: Mitchellville & Vicinity; Population: 2,102; Status: P-0%; Estimated Total Project Cost: \$801,000. Estimated completion date is developer dependent. No WSSC rate supported debt will be used for this project.

| |
|--|
| E. Annual Operating Budget Impact (000's) |
| |

| |
|---|
| F. Approval and Expenditure Data (000's) |
| |

| |
|------------------------------|
| G. Status Information |
| |

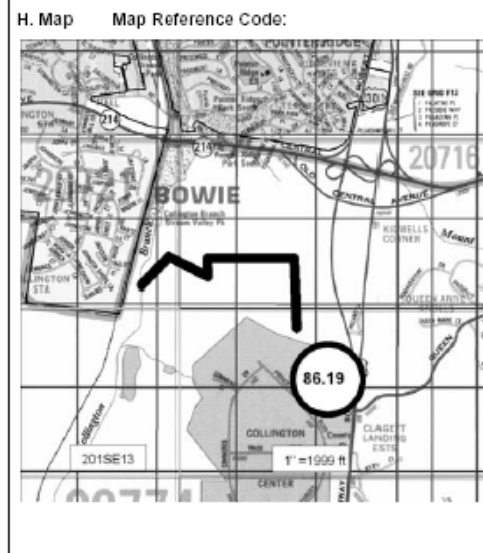

S-86.19_mBracke_9-22-06_03

Printed: 9/22/2006 3:38:23 PM