



February 27, 2025

Prince George's County Council Transportation, Infrastructure, Energy and Environment Committee

AGENDA



Introductions

Project Overview

Construction Update



PURPLE LINE LEADERSHIP



Ray Biggs, II
MDOT MTA



Doran Bosso
Purple Line Transit
Partners



Alberto Pinacho
Maryland Transit
Solutions



Luis Rivera
Purple Line Transit
Operators

PUBLIC-PRIVATE PARTNERSHIP STRUCTURE

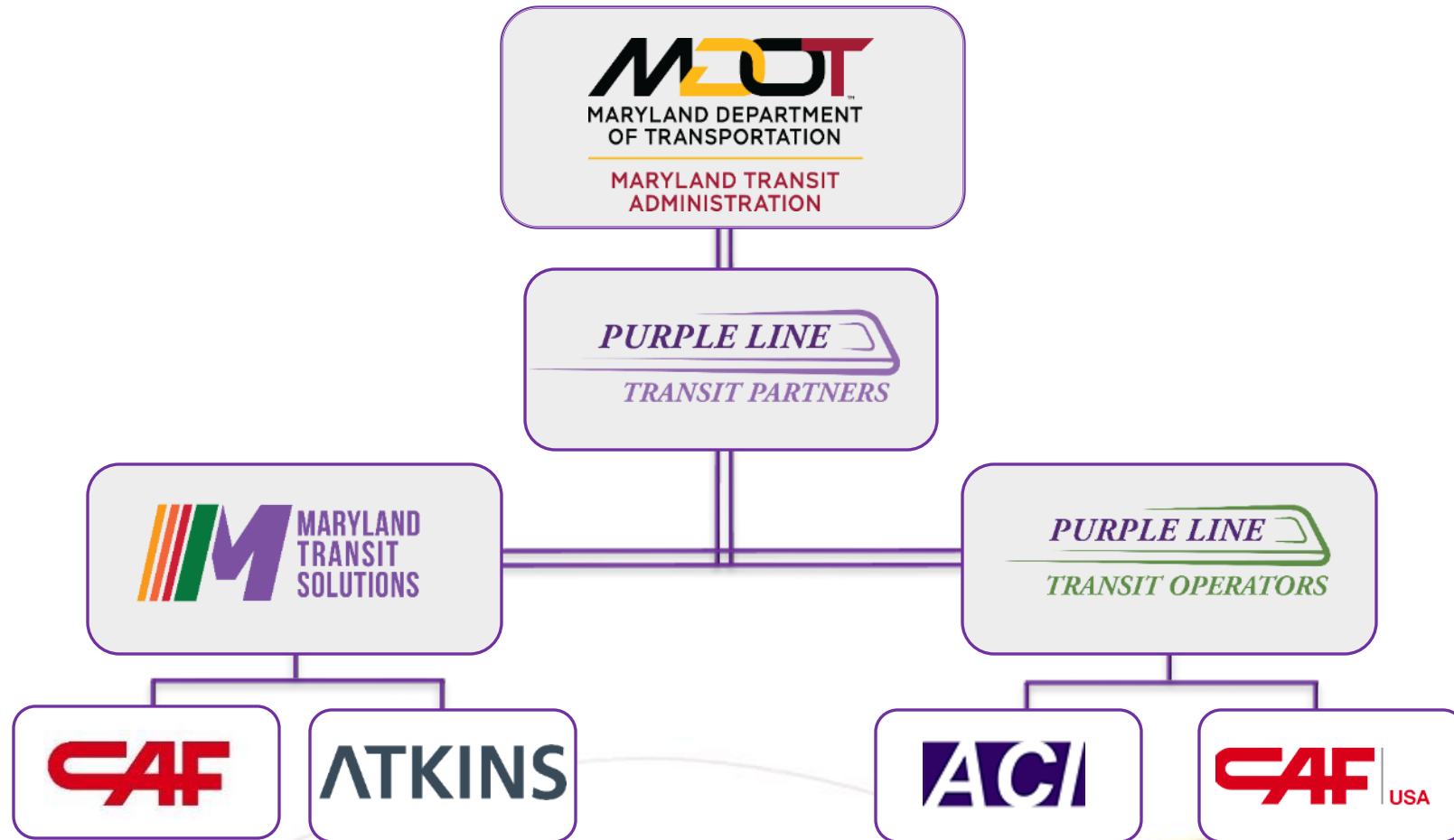

PURPLE LINE ALIGNMENT

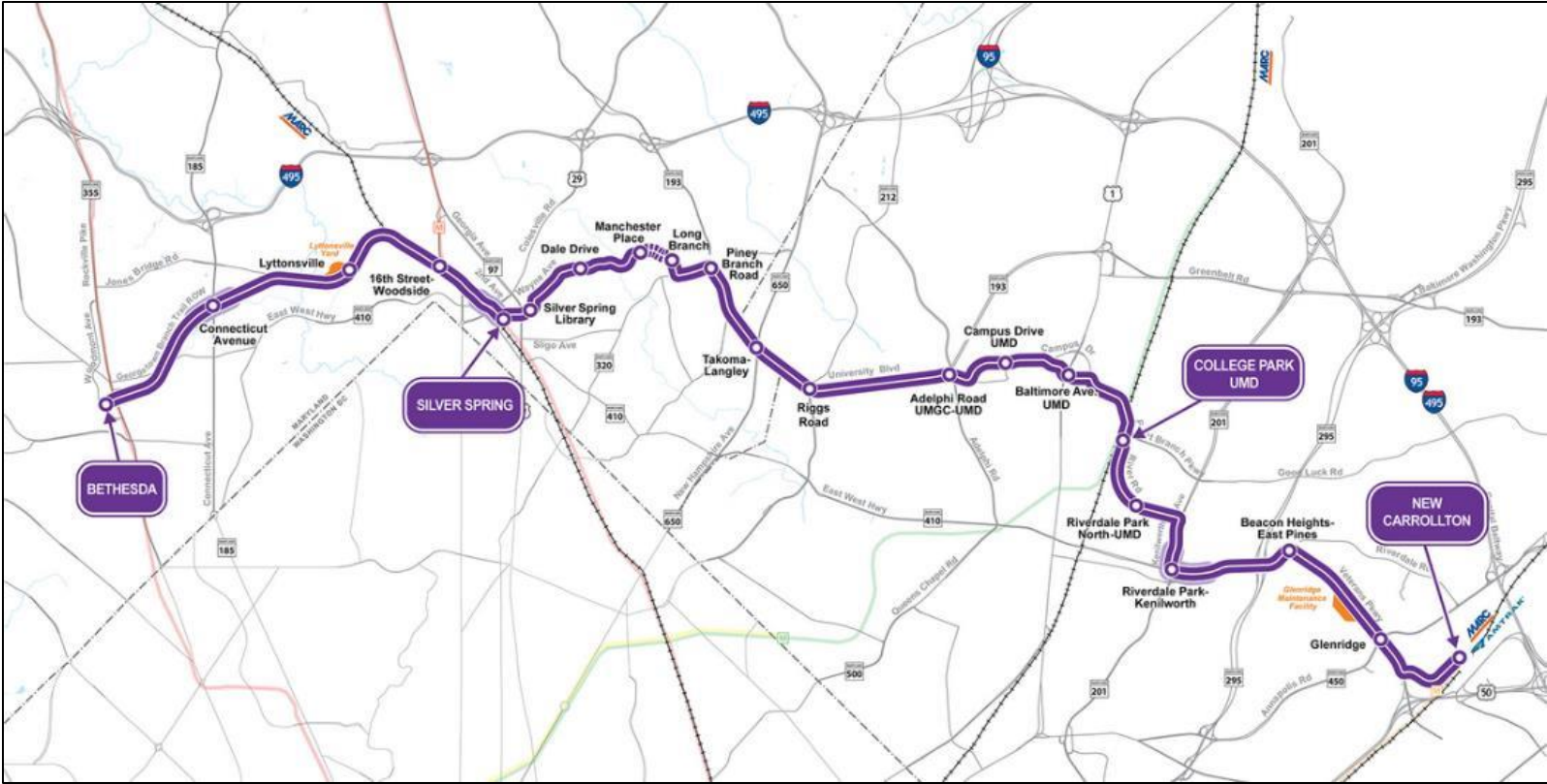

PROJECT TIMELINE



2022

2023

2024

2025

2026

2027

Spring
MTS
Contract
Signed

Summer
MTS begins
Full-Scale
Construction

Spring
Light Rail
Delivery
to OMF

Summer
Complete
Test Track

Spring
Start
Dynamic
Testing

Summer
Complete
Track
Installation

Spring
Start
End-to-End
System
Testing

Winter
Passenger
Service
Begins

PROJECT ACCOMPLISHMENTS



- 35% of track complete.
- Several miles of sidewalk complete.
- 20 of 21 stations are under construction.
- 12 station canopies installed.
- Project is more than 74% complete.
- Opened Talbot Avenue Bridge in May 2024.



LIGHT RAIL VEHICLES

- 8 of 28 light rail vehicles have been delivered to the Operations and Maintenance Facility; delivery will continue throughout 2025.
- 432-person total capacity with 80 seats available.
- Flex space and folding seats allow placement of 8 wheelchairs and 8 bicycles.
- Low floor with wide doorways for easy boarding.

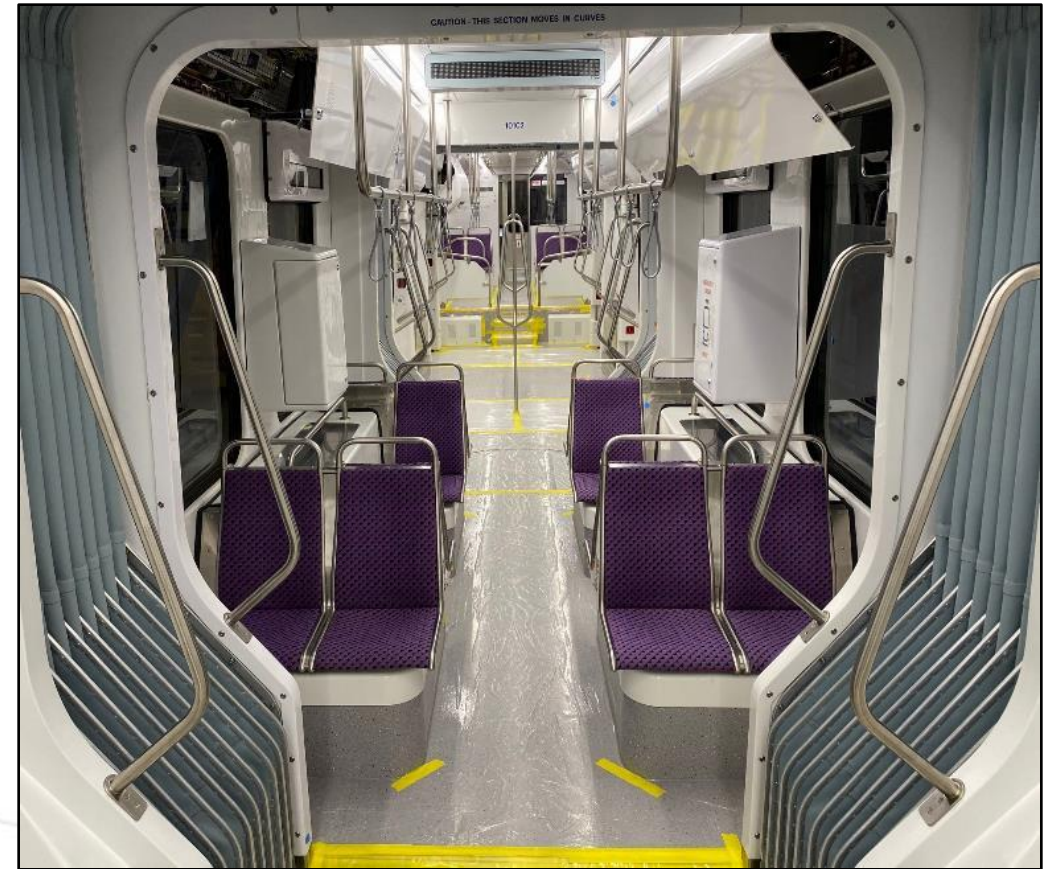

CONSTRUCTION PROGRESS



- University Boulevard
- Takoma-Langley Station
- New Hampshire Avenue
- Riggs Road
- Campus Drive and Adelphi Road
- Presidential Drive
- University of Maryland
- Baltimore Avenue-Route 1
- Campus Drive
- College Park Metro
- River Road
- Kenilworth Avenue
- Riverdale Park-Kenilworth Station
- Riverdale Road
- Beacon Heights Station
- Veterans Parkway
- Annapolis Road
- Ellin Road
- New Carrollton Station

UNIVERSITY BOULEVARD

Recent and Ongoing Work:

- Piney Branch Road and Riggs Road station platform and canopy are complete.
- Track installation progressing on University Boulevard (38% complete).
- Canopy artwork component has been installed.
- New sidewalks and curbs 99% completed.

Upcoming Work:

- Continue track installation along University Boulevard, including Riggs Road and New Hampshire Avenue intersections.
- Install the windscreen artwork element.
- Begin Overhead Catenary System installation.



TAKOMA-LANGLEY STATION



Recent and Ongoing Work:

- Maintenance of Traffic shifted to establish work zone in the center of the University Boulevard from Piney Branch Road to New Hampshire Avenue.
- Demolition of existing road surface is underway.
- Station Art-in-Transit elements in production.
- Complete the excavation for station foundations.

Upcoming Work:

- Start station platform foundations March 2025.
- Complete station structure by end of 2025.



TAKOMA-LANGLEY STATION ACCESS



- Station will offer easy connections to the Takoma Langley Crossroads Transit Center.
- Station will give riders access to businesses at each corner of the New Hampshire Avenue and University Boulevard intersection.
- Area will feature upgraded pedestrian infrastructure including crosswalks and signals.

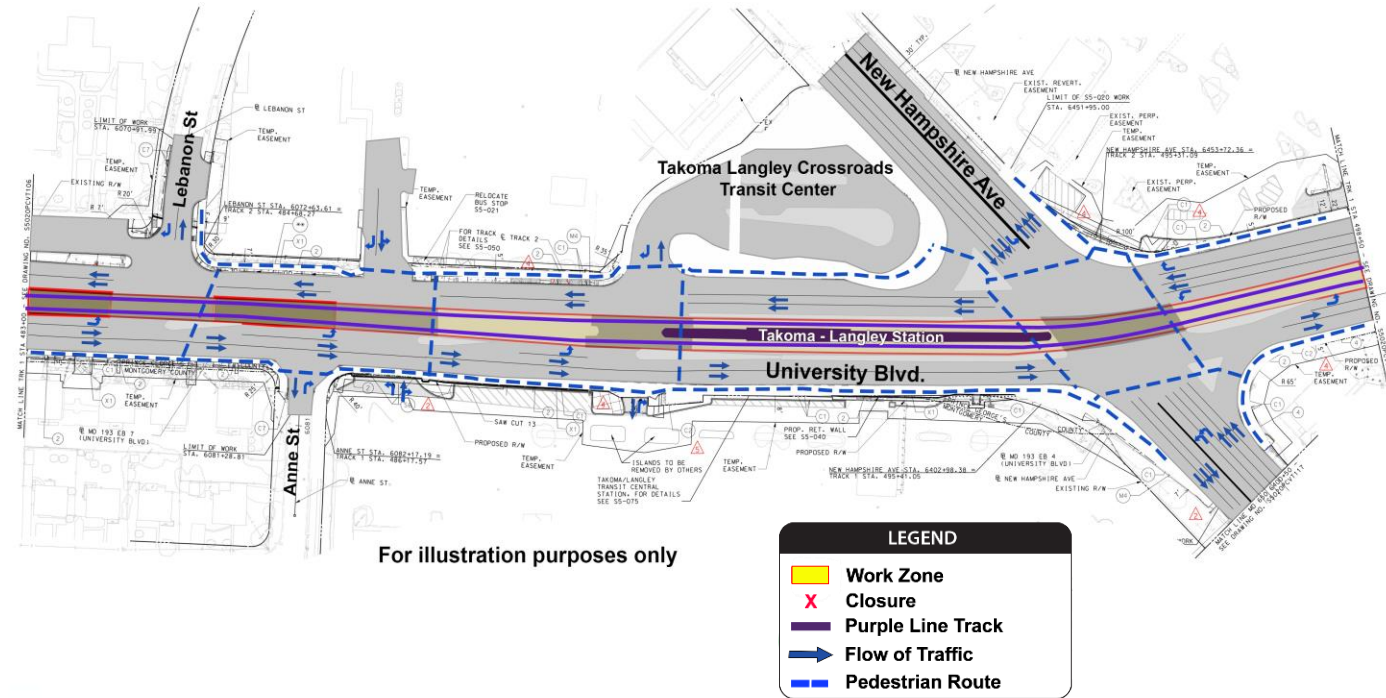

NEW HAMPSHIRE AVENUE (MD 650) & UNIVERSITY BOULEVARD (MD 193)



March 28 - April 27, 2025

- **Right turn only** from New Hampshire Avenue onto University Boulevard and from University onto New Hampshire Avenue.
- Pedestrian crosswalks will be maintained.

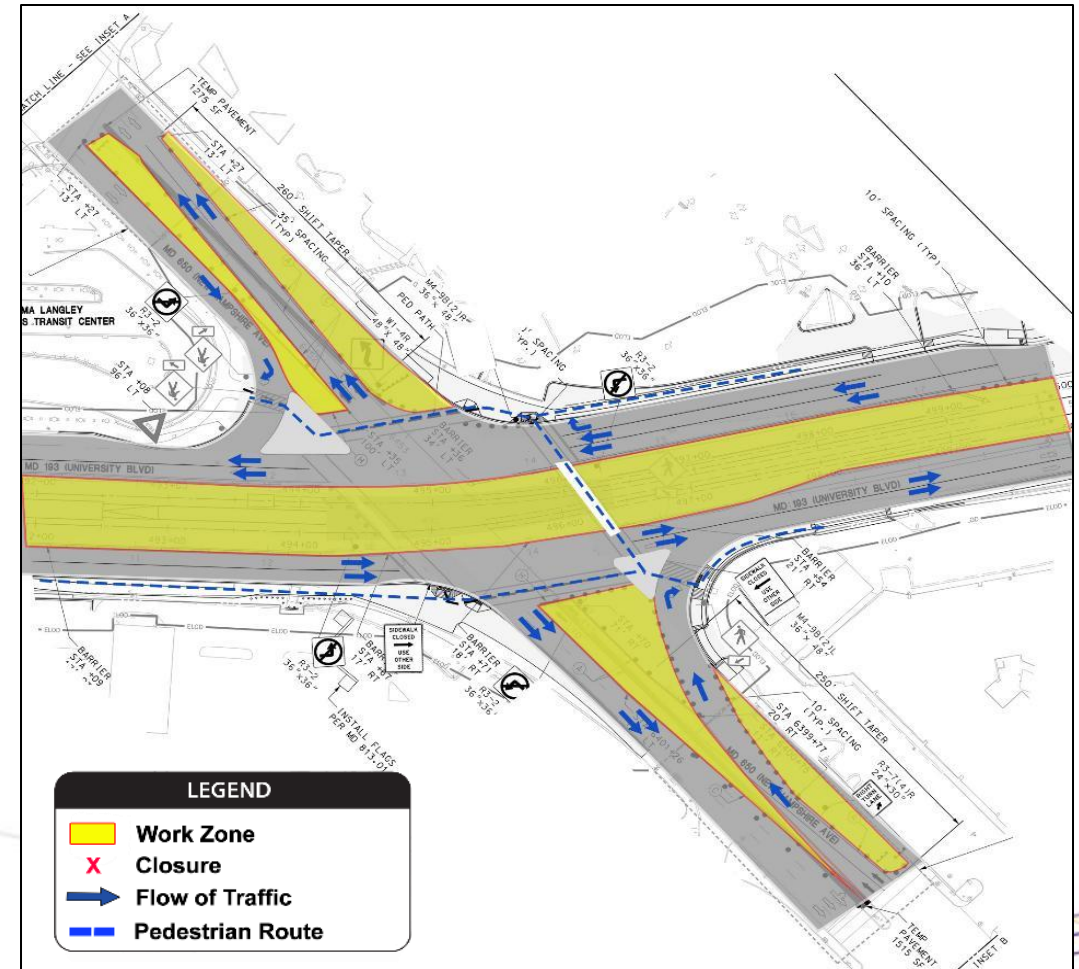

NEW HAMPSHIRE AVENUE (MD 650) & UNIVERSITY BOULEVARD(MD 193) - *DETOURS*



March 28 - April 27, 2025

- Detour routes include advanced detour options to shift traffic away from the intersection and local roads.



Southbound New Hampshire Ave. & Westbound University Boulevard Left Turn Detour Route.



Advanced Southbound New Hampshire Ave. Detour Route.



Northbound New Hampshire Ave. & Eastbound University Boulevard Left Turn Detour Route.



Advanced Northbound New Hampshire Ave. Detour Route.

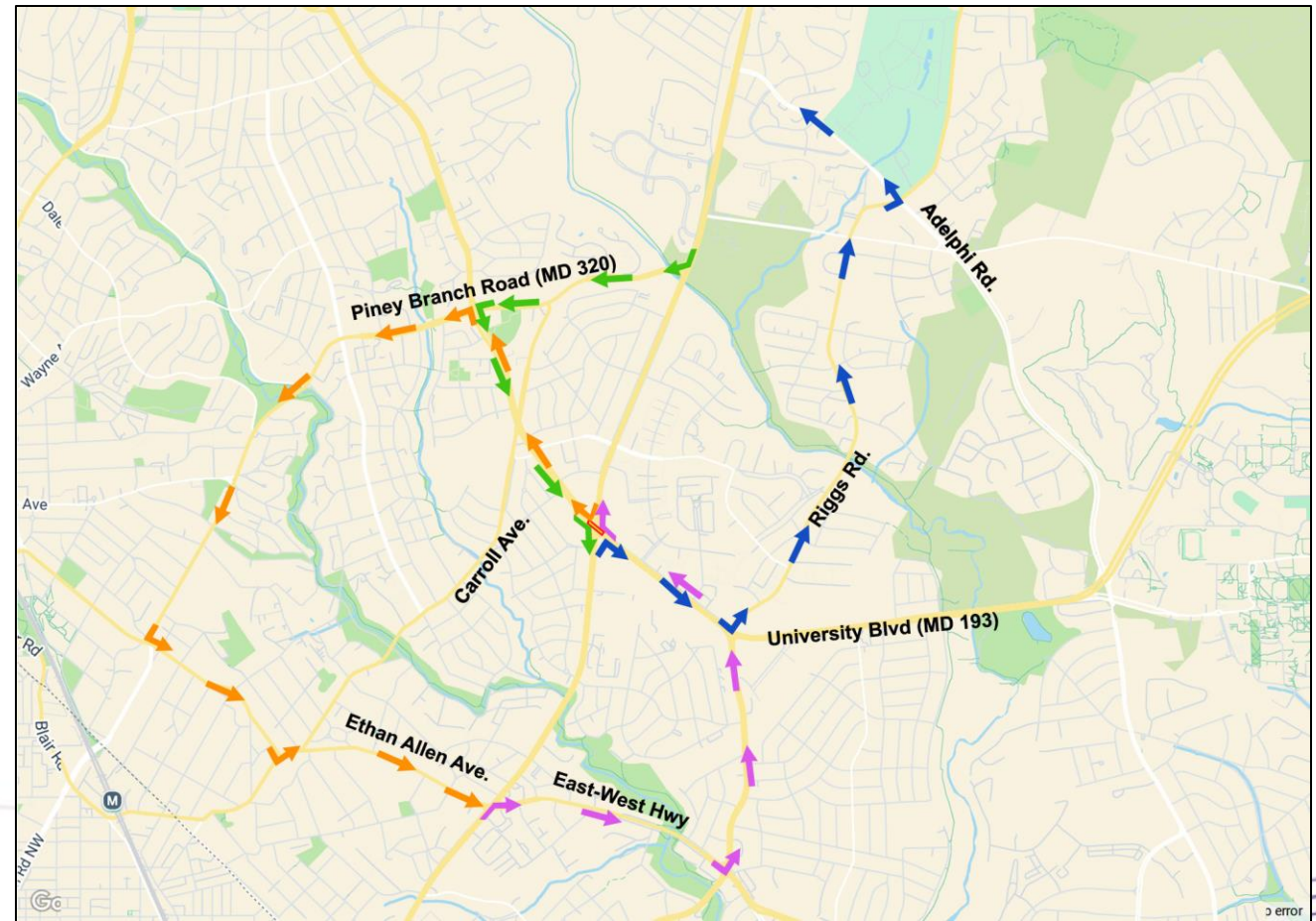

RIGGS ROAD (MD 212) & UNIVERSITY BOULEVARD (MD 193) - *DETOURS*



February 27 – March 27, 2025

- Detour routes include advanced detour options to shift traffic away from the intersection and local roads.



Southbound Riggs Road & Westbound University Boulevard Left Turn Detour Route.



Advanced Southbound Riggs Road Detour Route.



Northbound Riggs Road & Eastbound University Boulevard Left Turn Detour Route.



Advanced Northbound Riggs Road Detour Route.

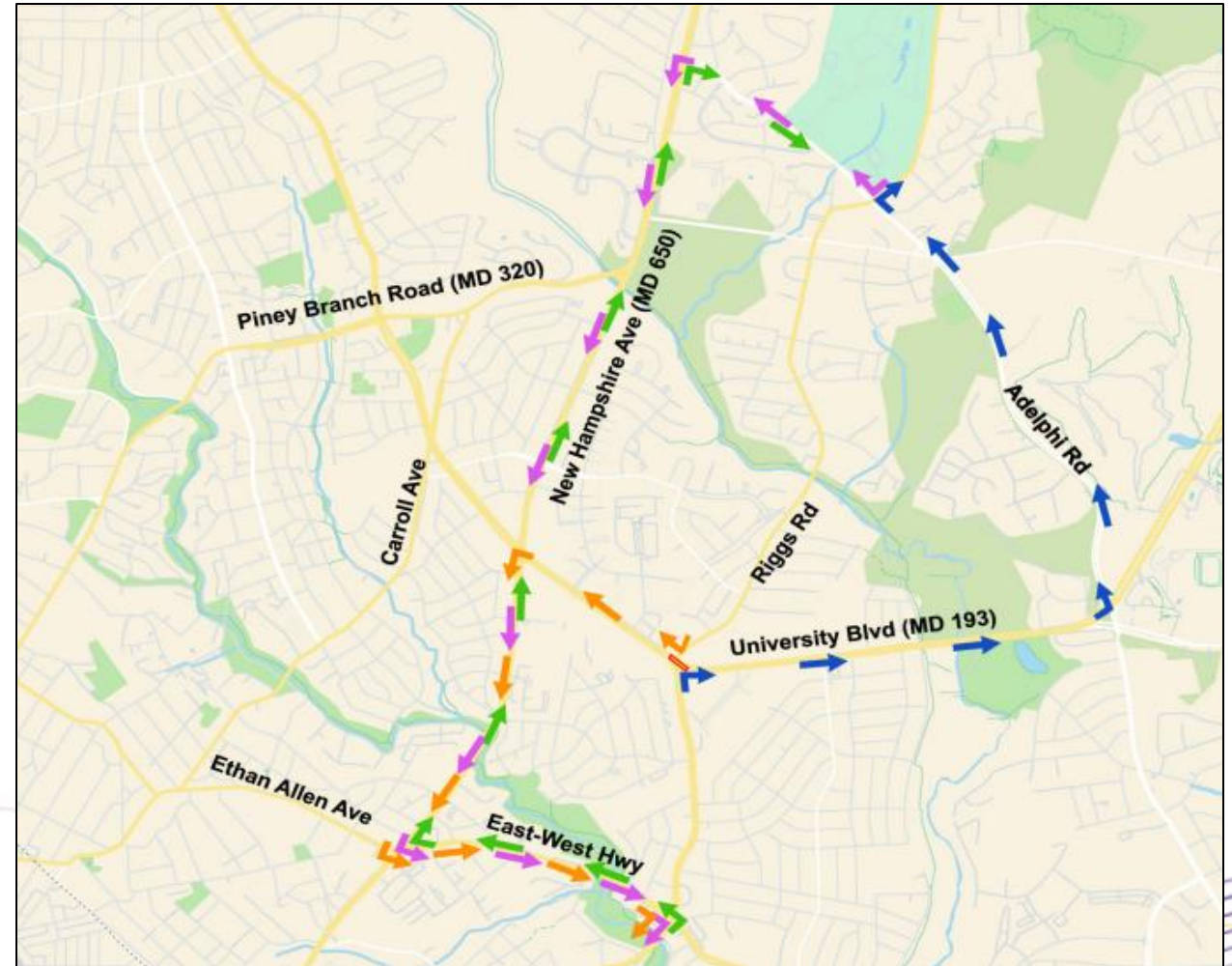

RIGGS ROAD (MD 212) & UNIVERSITY BLVD (MD 193)



February 27 – March 27, 2025

- **Right turn only** from Riggs Road onto University Boulevard and from University Boulevard onto Riggs Road.
- Pedestrian crosswalks will be maintained.

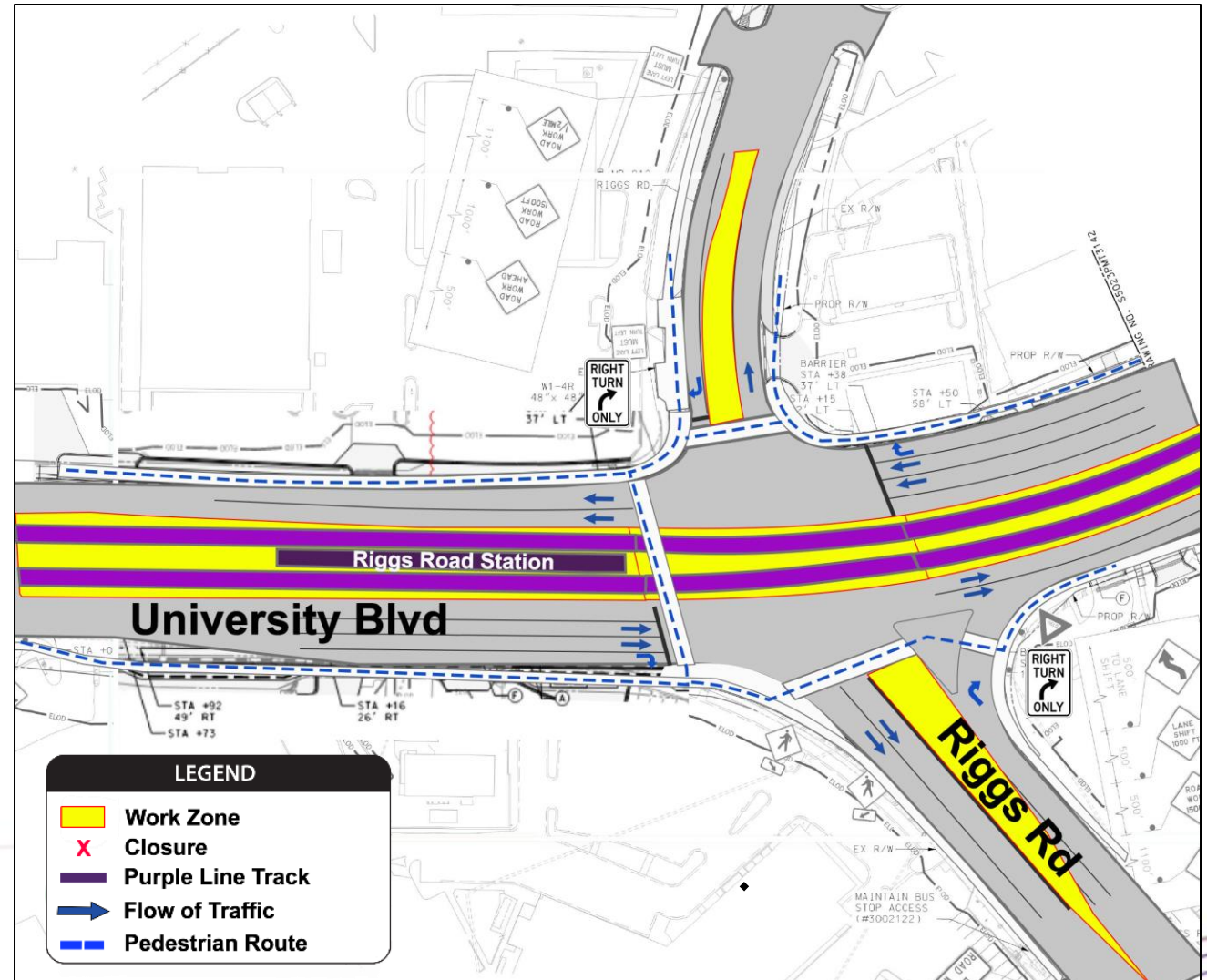

CAMPUS DRIVE AND ADELPHI ROAD



Recent and Ongoing Work:

- Purple Line tracks have been installed across Adelphi Road.
- Lane closures have been removed and left turns onto Campus Drive have been restored.
- Curbs and sidewalks have been installed.
- Utility systems have been installed.

Upcoming Work:

- Final paving.
- Complete signal adjustments.
- Overhead Catenary System (OCS) installation.



ADELPHI ROAD-UMGC-UMD STATION



Recent and Ongoing Work:

- Station platform completed.
- Station canopy installed.
- Preparations for track installation.

Upcoming Work:

- Complete track installation.
- Continue station systems installation.
- Install Art-In-Transit station elements.



PRESIDENTIAL DRIVE

Recent and Ongoing Work:

- Complete stormwater drainage.
- Prepare site for track installation.
- Installed 12 planter boxes.
- 30% curb and sidewalk completed.

Upcoming Work:

- Complete track installation.
- Install utilities.
- Complete sidewalk installation.



UNIVERSITY OF MARYLAND



Recent and Ongoing Work:

- Completed track installation from Presidential Drive to Rossborough Lane.
- Completed sidewalks and bicycle trails through campus.
- Installed 100% of OCS poles in the center of UMD campus.
- Installed 80% of light poles.

Upcoming Work:

- Complete track installation on Presidential Drive.
- Install OCS wires and systems.
- Complete sidewalks.
- Complete tracks to Baltimore Avenue (Rt 1).
- Complete bike path on UMD Campus.



BALTIMORE AVENUE (ROUTE 1)

On or about March 1

- Install tracks and final utilities across Baltimore Avenue.
- Placement of track will be done in two parts starting with the western half of the road.
- Traffic will be reduced to one lane in each direction and shifted first to the east half then to the west of the road.
- Track work to be completed by beginning of Summer.

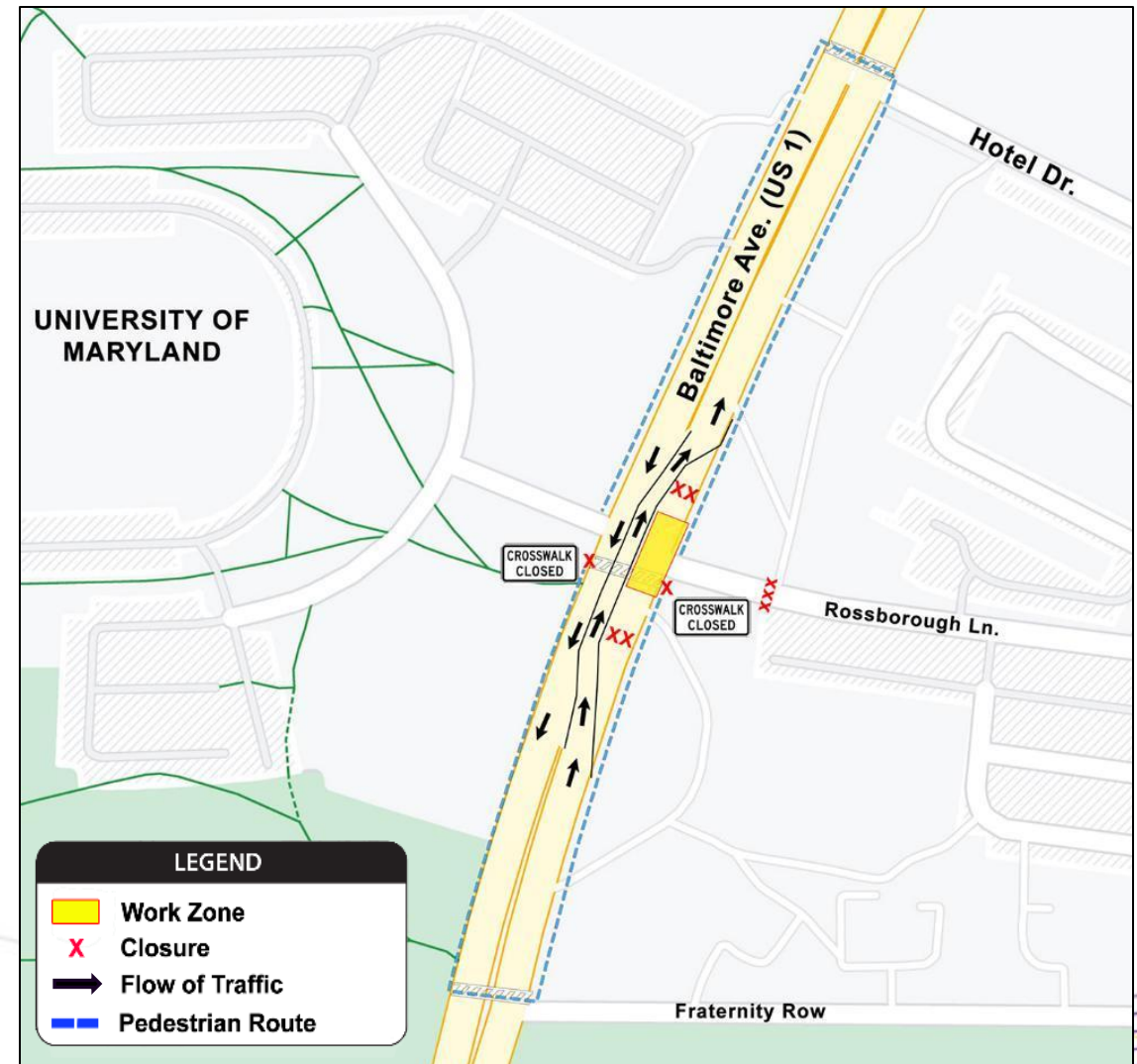

CAMPUS DRIVE FROM ROSSBOROUGH TO RIVER ROAD



Recent and Ongoing Work:

- Drainage systems completed.
- Multiple utility crossings and connections.
- Installed duct banks.
- Completed curb and sidewalks.
- Installed both sets of tracks.

Upcoming Work:

- Shift traffic to north side of Campus Drive.
- Complete road reconstruction.



COLLEGE PARK METRO – CAMPUS DRIVE



Recent and Ongoing Work:

- Complete track installation from underpass to Metro station area.
- Complete utility installation.
- Completed track installation along Metro station.

Upcoming Work:

- Finish track installation where the temporary garage access was located.



COLLEGE PARK – UMD STATION



Recent and Ongoing Work:

- Completed station platform.
- Installed canopy.
- Installation of Traction Power Substation.
- Direct fixation track 80% completed.

Upcoming Work:

- Continue station elements.
- Continue track placement.



RIVER ROAD

Recent and Ongoing Work:

- 55% track installed in River Road.
- Began fence installation.

Upcoming Work:

- Continue system utilities.
- Complete track placement.
- Complete curb and sidewalk.



KENILWORTH AVENUE

Recent and Ongoing Work:

- Moved traffic to center of Kenilworth Avenue.
- Installed curved tracks from River Road to Kenilworth.
- Installed stormwater drainage.
- Installed curb, sidewalks and driveway connections (90% complete).
- Completed track placement at Rittenhouse Street.

Upcoming Work:

- Complete track installation.



KENILWORTH AVENUE TO RIVERDALE PARK

KENILWORTH STATION



Recent and Ongoing Work:

- Completed ramp construction.
- Completed concrete for flyover.
- Installed canopy, windscreens and fencing for the station.
- Started track installation.
- Started the elevator and stair access to the station.

Upcoming Work:

- Continue track installation.
- Complete the elevator and stair access to the station.
- Complete station utilities.



RIVERDALE ROAD

Recent and Ongoing Work:

- Completed track installation through Baltimore-Washington Parkway underpass.
- Completed track across 67th Avenue.
- Installation of utilities continues.
- 90% completed architectural stonework at Baltimore-Washington Parkway bridges.
- Completed track across 66th Avenue.

Upcoming Work:

- Continue track installation from Riverdale Park-Kenilworth station to Veterans Parkway.



BEACON HEIGHTS STATION

Recent and Ongoing Work:

- Installed canopy.
- Installed tracks through station.

Upcoming Work:

- Continue station elements.



VETERANS PARKWAY – TEST TRACK



Recent and Ongoing Work:

- Completed track installation.
- Completed OCS pole installation.
- Completed OCS power connections.

Upcoming Work:

- Complete system testing to facilitate dynamic vehicle testing.



ANNAPOLIS ROAD AND VETERANS PARKWAY



Recent and Ongoing Work:

- Completed track installation.
- Completed OCS pole installation.
- Completed curbs.
- Began new traffic signal installation.

Upcoming Work:

- Complete traffic signal.
- Restore intersection movements.



ELLIN ROAD

Recent and Ongoing Work:

- Completed track installation from Hanson Oaks to Emerson Place.
- Started OCS installation.

Upcoming Work:

- Continue OCS installation.
- Continue sidewalks and curbs.



NEW CARROLLTON STATION

Recent and Ongoing Work:

- Completed new bus loop.
- Began foundations for new station.
- Installed utilities.
- Installed walls along tracks.

Upcoming Work:

- Continue station construction.
- Continue track installation.
- Continue sidewalks and curbs.



TRAIN TESTING

Test Track Location

- Adjacent to the Glenridge Operations and Maintenance Facility.
- 1 mile – Parallel to Veterans Parkway (MD 410) between Annapolis Road & Riverdale Road.
- Test Track will be utilized for dynamic running tests of the trains.

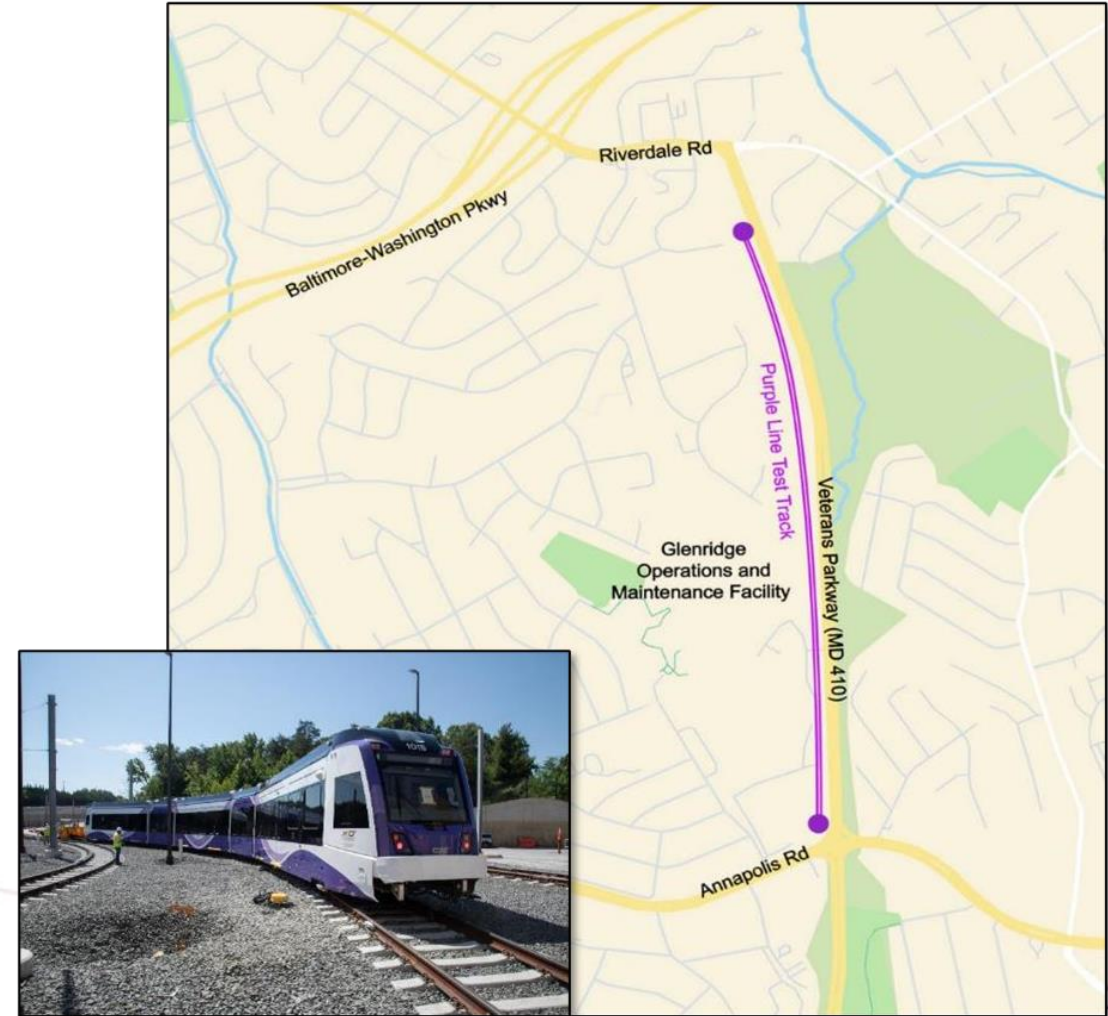

TRAIN TESTING

Test of Train Systems

- Braking and Propulsion.
- Vehicle Safety Systems - automatic vehicle locator, emergency communications.

Training

- Operator training.
- First Responder Training – MTA Police and Prince George's County Police and Fire Departments.

Site Safety

- Dedicated alignment – no access for public.
- No road crossings or interaction with motorists.
- State-of-the-art vehicle overrun protection.



TRAIN TESTING

Current Status

Trains

- 8 trains delivered and static tested.
- Remaining 20 planned to be delivered and static tested this year.

Trackwork

- Tracks built and tamped.
- Inspection and testing in progress.

Traction Power

- Substation installed and tested.
- Power cable installation in progress.

Overhead Catenary System

- Poles, brackets, tension wire complete.
- Contact wires, sectionalizing switches complete.
- Testing in progress.



PURPLE LINE TRANSIT OPERATORS



Recent and Ongoing Work:

- Completed training for Train Operators and Rail Director to support Dynamic Testing.
- Finalized train maintenance modules for PLTO team.
- Moved PLTO HQ to the Operations & Maintenance Facility (OMF) in Glenridge.

Upcoming Work:

- Hiring direct line operating and maintenance staff as the project progresses.
- Continuing training to certify PLTO operating and maintenance team.
- Supporting the Dynamic Testing.



2025 ANTICIPATED MILESTONES



- Start of Train Dynamic Testing.
- Delivery of all 28 trains.
- First of the 21 station structures completed, with all under construction.
- Art-in-Transit installations underway.



ELECTED OFFICIAL ALERTS





Purple Line Outreach produces and deploys multiple advance resources for elected officials each month.

- **Progress Highlight Summaries:** a recap of the latest construction progress, road impacts, project completion percentages and photos.
- **Road Access Alerts:** three areas in each county, highlighted with map graphics. These flyers are provided in English and Spanish.



Purple Line Road Access Alerts Prince George's County, February 3, 2025





The temporary traffic shift on Adelphi Road at Campus Drive will continue through mid-February 2025. Northbound Adelphi Road is reduced to one through lane at the intersection. Left turns from north and southbound Adelphi Road onto Campus Drive are eliminated during this time. This traffic shift is to facilitate track construction across the intersection.

On or about February 6, 2025, 24th Avenue will be limited to right turns only at the intersection with University Boulevard (MD 193) for approximately three weeks. Crews will establish a work zone in the center of University Boulevard to facilitate the installation of tracks and other utilities.

On or about February 27, 2025, Riggs Road will be limited to right turns only at the intersection with University Boulevard to facilitate track and utility installation. The pedestrian crossing of University Boulevard will remain at Riggs Road. Additional signage will be in place to direct drivers to use the advanced detour routes to minimize the number of vehicles at the University Boulevard intersection.



The Purple Line is a 16-mile light rail line that will extend from New Carrollton in Prince George's County to Bethesda in Montgomery County. It will provide a direct connection to the Metrorail Red, Green and Orange Lines, at Bethesda, Silver Spring, College Park, and New Carrollton. The Purple Line will also connect to MARC, Amtrak, and local bus services.

Phone: 443-451-3706 or
443-451-3705 (Español)
Email: outreach@purplelinemd.com
Website: purplelinemd.com

COMMUNITY OUTREACH

- **Moles (industry organization for heavy construction) Student Day** – hosted in fall 2024.
- **Safety Campaign** - Developed a 2024 campaign for UMD focused on safety for bikes, scooters, and skateboards.



BUSINESS ENGAGEMENT



- Early alerts about construction activities that may impact businesses are provided through team member visits and flyers printed in English and Spanish.
- Project-adjacent businesses are promoted with YouTube video spotlights, newsletter features, social media and installed signage.
- MDOT **Small Business Grants Program** for the Purple Line launched on February 10, 2025, to support businesses impacted by construction.



SMALL BUSINESS GRANTS PROGRAM



Small Business Grant Program

The Purple Line Small Business Grant Program is operated by the Maryland Department of Transportation (MDOT) to provide support to small businesses located along the Purple Line corridor that are impacted by construction.

Benefits

Direct grants up to \$50,000, payable to eligible small businesses, are intended to offset the impact that construction closures or detours may have on business operations and may be used to pay any business expenses.

Eligibility

To be eligible for a grant, businesses must be in good standing with the Maryland State Department of Assessment and Taxation, federal and State taxing and licensing authorities, and in operation within one-quarter mile of the existing or future Purple Line alignment prior to January 1, 2022.

Learn more about eligibility, deadlines, and download the application at purplelinemd.com



- Launched February 10, 2025.
- Applications due March 14, 2025.
- <https://purplelinemd.com/small-business-grants/>

COMMUNITY SUPPORT



- Purple Line Transit Partners awarded 12 **Beyond the Rails** grants in 2024 and 8 in January 2025.
- Awards distributed every 6 months.
- Recent recipients include:
 - City of New Carrollton
 - Riverdale Heights/Riverdale Hills/Crestwood Community Association
 - Beacon Heights Citizen Association
- Grants valued between \$1,000 and \$3,000.
- Now accepting new applicants for May 2025 cycle.



CAT MEMBER ENGAGEMENT



- The Outreach Team will hold two listening sessions with CAT members scheduled the week of February 24.
- The team is working with community advocacy groups to increase the promotion of CAT meetings.
- YouTube views of the meetings reached record numbers in 2024.





Register for Construction Updates: purplelinemd.com

Email Us:

outreach@purplelinemd.com or media@purplelinemd.com

Call Us:

443-451-3706 / 443-451-3705 (Español)

Follow Us:

[@purplelinemd](https://twitter.com/purplelinemd)



PURPLE LINE NEWSLETTER
JANUARY 2025

- Construction Updates
- Business Spotlight: Address International Market
- People Behind the Purple Line: Head Coach, Purple Line Safety Program Manager

From Ray Biggs, II
Purple Line Senior Project Director, MTA

in 2024, the Purple Line...
Safety is our top priority for the Purple Line project and our "Building the Purple Line" Southern Maryland Station, the Purple Line Safety Program Manager. We're sure you were kept up to date on the progress of the project.

Our Business Spotlight this month is Address International Market in Collegeville, an area just west of the Purple Line Station. We spoke with the owners of Address, who lead us in a tour of the site and the progress of the project. We'll be back with you on the future of the Purple Line project.

We hope you're excited about the Purple Line project and the progress of the project. We'll be back with you on the future of the Purple Line project.

Don't forget to follow us on our social media channels for the latest news and updates. You can also reach out to us via email at outreach@purplelinemd.com or by calling 443-451-3706 (Spanish: 443-451-3705).

Stay tuned for more updates on the Purple Line!

Purple Line Road Access Alerts
Montgomery County,
February 3, 2025

On or about January 27, 2025, crews began periodic lane closures during nighttime at the intersection of Wayne Avenue and Fenton Street for approximately two weeks. These lane closures are necessary to facilitate utility testing.

On or about February 17, 2025, crews will reduce Stewart Avenue to one lane starting at Brookville Road with alternating traffic for approximately three months. Parking on Stewart Avenue will be limited. This closure is necessary to track placement across Stewart Avenue.

On or about February 27, 2025, Riggs Road will be limited to right turns only at the intersection with University Boulevard (MD 193) for approximately four weeks. Crews will establish a work zone in the center of University Boulevard to facilitate track and utility installation. The pedestrian crossing of University Boulevard will remain at Riggs Road. Additional signage will be in place to direct drivers to use the advance detour routes to minimize the number of vehicles at the University Boulevard intersection.

The Purple Line is a 16-mile light rail line that will extend from New Carrollton in Prince George's County to Bethesda in Montgomery County. It will provide a direct connection to the Metrolink, Green and Orange Lines, all Bethesda, Silver Spring, College Park, and New Carrollton. The Purple Line will also connect to MARC, Amtrak, and local bus services.

Phone: 443-451-3706 or 443-451-3705 (Español)
Email: outreach@purplelinemd.com
Website: purplelinemd.com

Questions?